

7

6

5

4

3

2

1

DO NOT SCALE. IF IN DOUBT ASK!

FIREFLY® 38mm TEK SCREWS SECURE THE CLAMPING CHANNEL TO THE SUPPORTING CHANNEL ABOVE AT 250mm CENTRES

41 x 41mm UNISTRUT CHANNEL

100mm MIN OVERLAP

41 x 41mm UNISTRUT CHANNEL OR 41 x 21mm UNISTRUT HALF CHANNEL

A BEAD OF FIREFLY® HIGH TEMPERATURE ADHESIVE

150mm NOMINAL OVERLAP

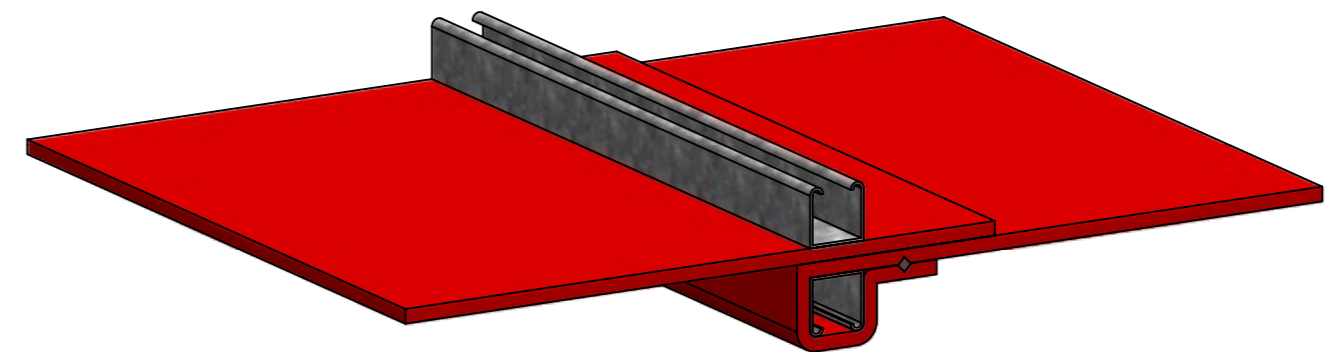
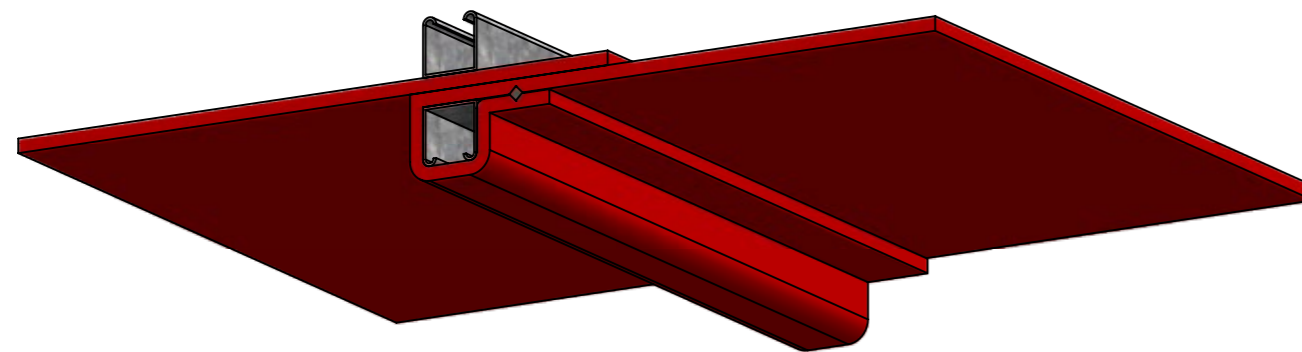

### PHOENIX - HORIZONTAL CLAMP FIX

TBA PROTECTIVE TECHNOLOGIES LTD  
 Unit 3, Transpennine Trading Estate,  
 Gorrells Way Rochdale, OL11 2PX,  
 United Kingdom  
 T: +44 (0)1706 758 817  
 E: Technical@TBAFIREFLY.COM  
 W: WWW.TBAFIREFLY.COM

DESIGNER: JC  
 APPROVED: KG  
 DATE: 28/08/2023  
 SCALE: NTS

DRAWING NO:  
**PH - 101B**  
 REVISION: 2  
 IN SEQUENCE: 1/1

All rights reserved. No parts of this drawing may be used reproduced, altered, stored in a retrieval system or transmitted in any form or by any means without the prior written permission of tba protective technologies ltd. Whilst every effort has been made to comply with the current statutory regulations, it is the user's responsibility to ensure that the final detailing and installation meets the requirements of relevant regulatory authority (often building control). Please check [www.tbafirefly.com](http://www.tbafirefly.com) to ensure that you are using the correct and current version. Copyright © 2023



7

6

5

4

3

2

1

7

6

5

4

3

2

1

DO NOT SCALE. IF IN DOUBT ASK!

FIREFLY® 38mm TEK SCREWS SECURING THE CLAMPING ANGLE TO THE UNISTRUT AT 250mm CENTRES

41mm x 41mm UNISTRUT CHANNEL

100mm MIN OVERLAP

25mm x 25mm x 0.7mm MIN THICK GALVANISED ANGLE CLAMPING BOTH INSTANCES OF THE BARRIER TO THE SUPPORTING UNISTRUT

A BEAD OF FIREFLY® HIGH TEMPERATURE ADHESIVE

150mm NOMINAL OVERLAP OF FIREFLY® BARRIER

FIREFLY® 38mm TEK SCREWS AND WASHERS SECURING THE OVERLAP TO THE CLAMPING ANGLE AT 600mm CENTRES

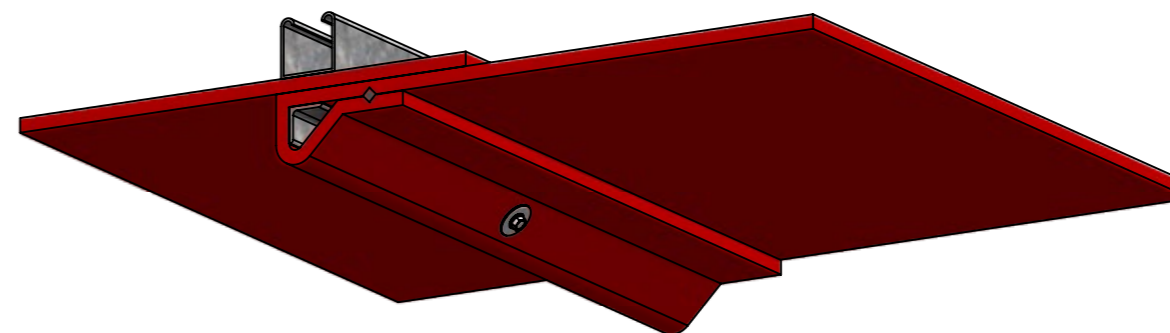
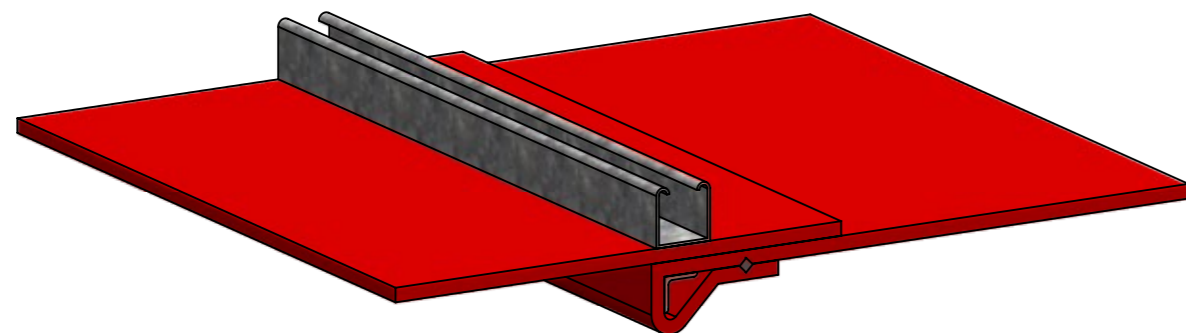

### PHOENIX - HORIZONTAL CLAMP FIX

TBA PROTECTIVE TECHNOLOGIES LTD  
Unit 3, Transpennine Trading Estate,  
Gorrells Way Rochdale, OL11 2PX,  
United Kingdom  
T: +44 (0)1706 758 817  
E: Technical@TBAFIREFLY.com  
W: WWW.TBAFIREFLY.COM

DESIGNER: JC

DRAWING NO:

APPROVED: KG

PH - 101

DATE: 28/08/2023

REVISION: 2

SCALE: NTS

IN SEQUENCE: 1/1

All rights reserved. No parts of this drawing may be used reproduced, altered, stored in a retrieval system or transmitted in any form or by any means without the prior written permission of tba protective technologies ltd. Whilst every effort has been made to comply with the current statutory regulations, it is the user's responsibility to ensure that the final detailing and installation meets the requirements of relevant regulatory authority (often building control). Please check www.tbafirefly.com to ensure that you are using the correct and current version. Copyright © 2023



7

6

5

4

3

2

1

DO NOT SCALE. IF IN DOUBT ASK!

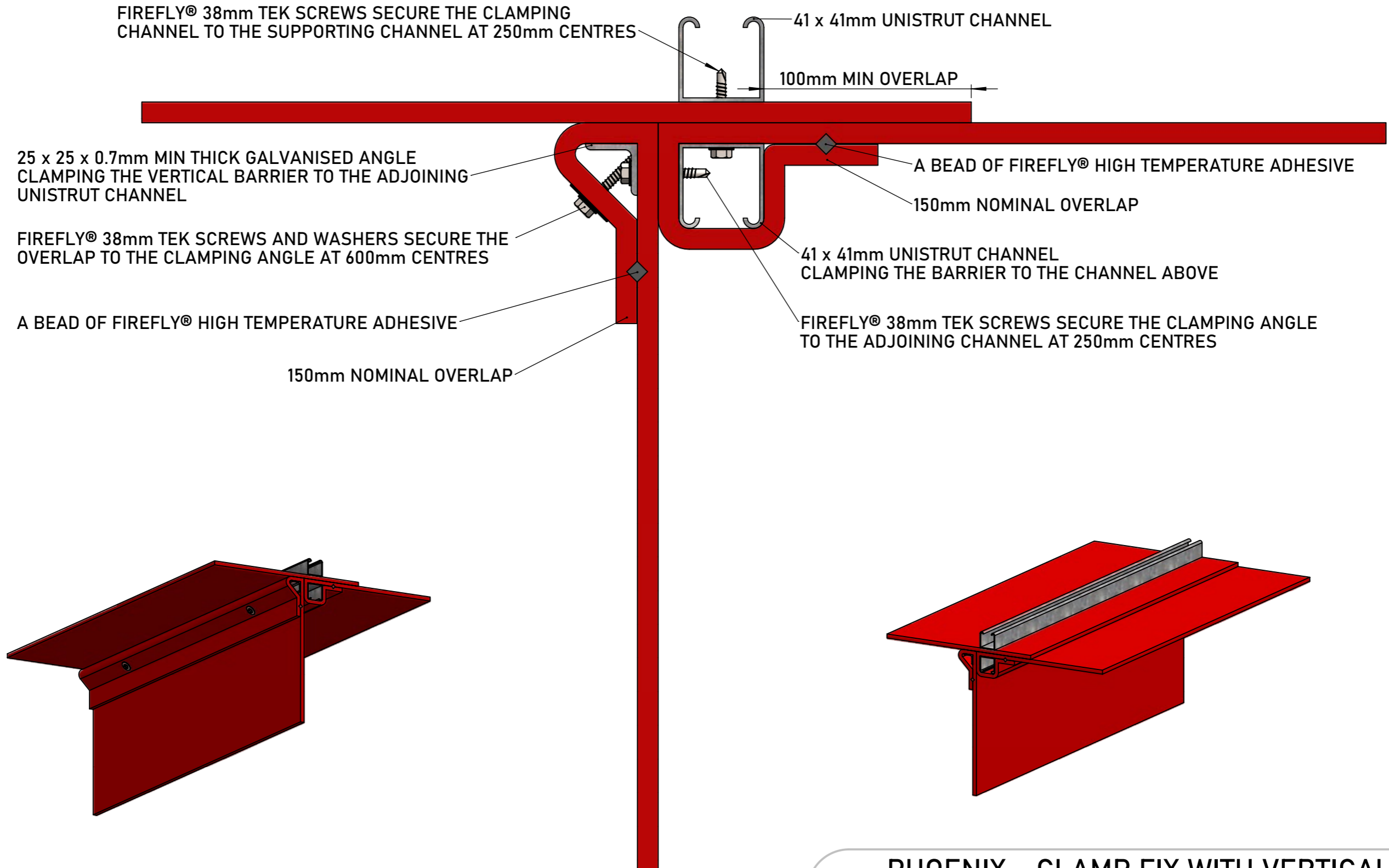

**PHOENIX - CLAMP FIX WITH VERTICAL DROP**

TBA PROTECTIVE TECHNOLOGIES LTD  
 Unit 3, Transpennine Trading Estate,  
 Gorrells Way Rochdale, OL11 2PX,  
 United Kingdom  
 T: +44 (0)1706 758 817  
 E: Technical@TBAFIREFLY.COM  
 W: WWW.TBAFIREFLY.COM

DESIGNER: JC	DRAWING NO:
APPROVED: KG	PH - 102B
DATE: 28/08/2023	REVISION: 2
SCALE: NTS	IN SEQUENCE: 1/1

All rights reserved. No parts of this drawing may be used reproduced, altered, stored in a retrieval system or transmitted in any form or by any means without the prior written permission of tba protective technologies ltd. Whilst every effort has been made to comply with the current statutory regulations, it is the user's responsibility to ensure that the final detailing and installation meets the requirements of relevant regulatory authority (often building control). Please check www.tbafirefly.com to ensure that you are using the correct and current version. Copyright © 2023



DO NOT SCALE. IF IN DOUBT ASK!

FIREFLY® 38mm TEK SCREWS SECURE THE 50 x 50 x 0.7mm ANGLE TO THE SUPPORTING CHANNEL AT 250mm CENTRES

25 x 25 x 0.7mm MIN THICK GALVANISED ANGLE, CLAMPING THE BARRIER TO THE SUPPORTING ANGLE

FIREFLY® 38mm TEK SCREWS SECURE THE 25 x 25 x 0.7mm ANGLE TO THE 50 x 50 x 0.7mm ANGLE AT 250mm CENTRES

FIREFLY® 38mm TEK SCREWS AND WASHERS SECURE THE OVERLAP TO THE CLAMPING ANGLE AT 600mm CENTRES

A BEAD OF FIREFLY® HIGH TEMPERATURE ADHESIVE

150mm NOMINAL OVERLAP

41 x 41mm UNISTRUT CHANNEL

100mm MIN OVERLAP.

A BEAD OF FIREFLY® HIGH TEMPERATURE ADHESIVE

150mm NOMINAL OVERLAP

FIREFLY® 38mm TEK SCREWS AND WASHERS SECURE THE OVERLAP TO THE CLAMPING ANGLE AT 600mm CENTRES

50 x 50 x 0.7mm MIN THICK GALVANIZED ANGLE CLAMPING THE HORIZONTAL BARRIER TO THE SUPPORTING CHANNEL AND ACTING AS A SUPPORTING BASE FOR FIXING THE VERTICAL DROP

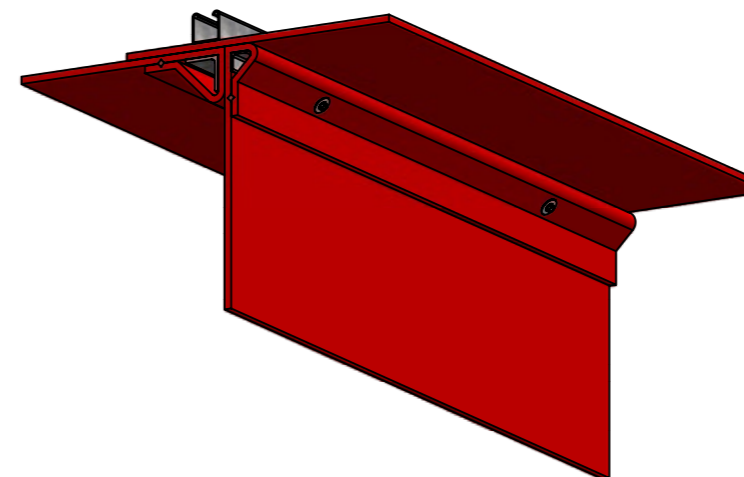
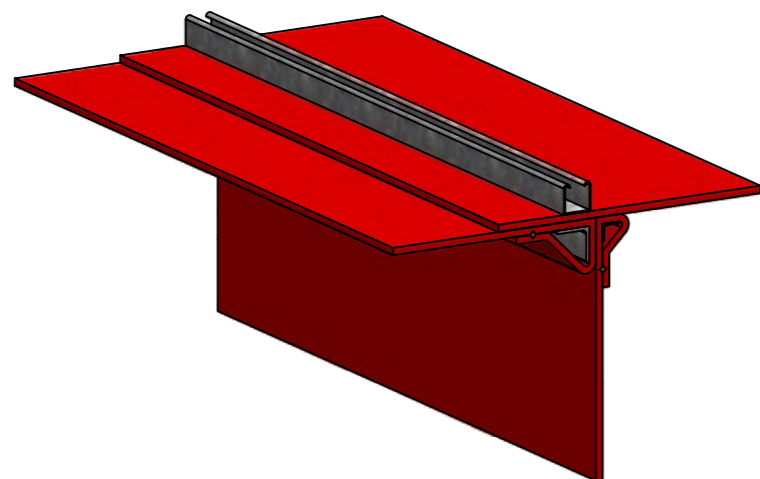

### PHOENIX - CLAMP FIX WITH VERTICAL DROP

TBA PROTECTIVE TECHNOLOGIES LTD

Unit 3, Transpennine Trading Estate,  
Gorrells Way Rochdale, OL11 2PX,  
United Kingdom

T: +44 (0)1706 758 817

E: Technical@TBAFIREFLY.com

W: WWW.TBAFIREFLY.COM

DESIGNER: JC

APPROVED: KG

DATE: 28/08/2023

SCALE: NTS

DRAWING NO:

PH - 102

REVISION: 2

IN SEQUENCE: 1/1

All rights reserved. No parts of this drawing may be used reproduced, altered, stored in a retrieval system or transmitted in any form or by any means without the prior written permission of tba protective technologies ltd. Whilst every effort has been made to comply with the current statutory regulations, it is the user's responsibility to ensure that the final detailing and installation meets the requirements of relevant regulatory authority (often building control). Please check [www.tbafirefly.com](http://www.tbafirefly.com) to ensure that you are using the correct and current version. Copyright © 2023



DO NOT SCALE. IF IN DOUBT ASK!

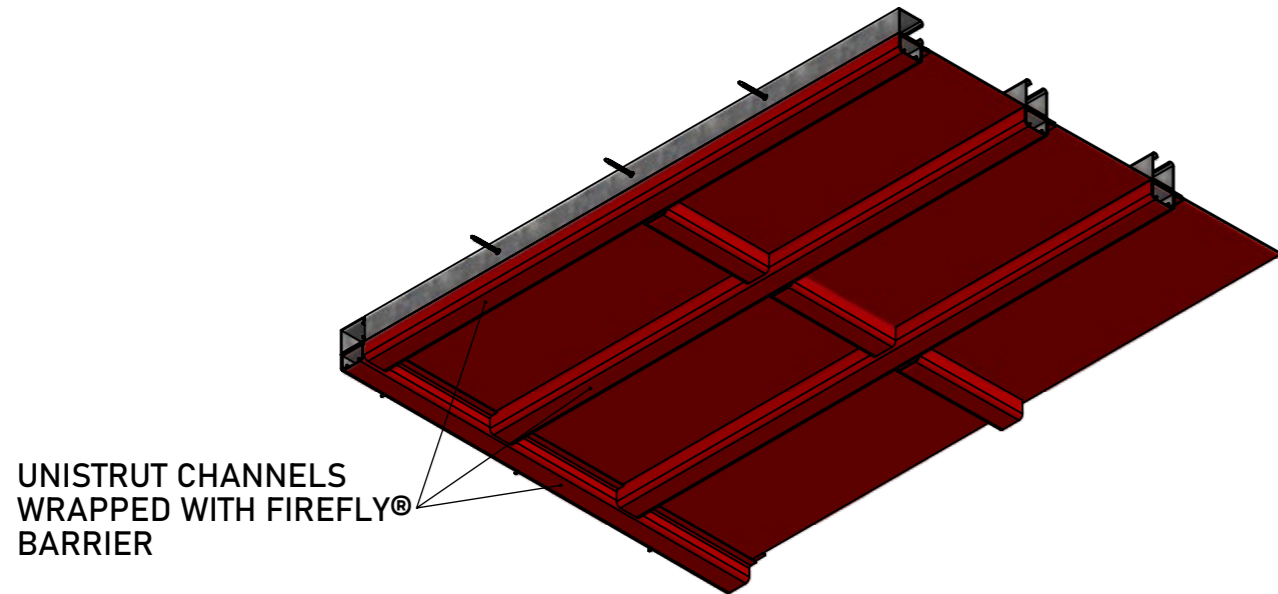

UNISTRUT CHANNELS WRAPPED WITH FIREFLY® BARRIER

UNISTRUT CHANNEL NUT WITH SPRING INSERTED FIRST AND ROTATED TO LOCK POSITION

UNISTRUT MOUNTING BRACKET

HEX BOLT SECURING THE MOUNTING BRACKET TO THE NUT

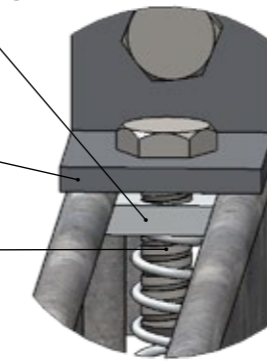

JOINING UNISTRUT'S

THE LIP OF THE UNISTRUT SLOTS INTO THE GROOVE OF THE NUT ANCHORING IT IN PLACE

LOCKING THE NUT WILL STABILIZE THE FIXING AND STRENGTHENS THE STRUCTURAL INTEGRITY OF THE UNISTRUT

CURVED EDGE ALLOWS FOR EASIER ROTATION

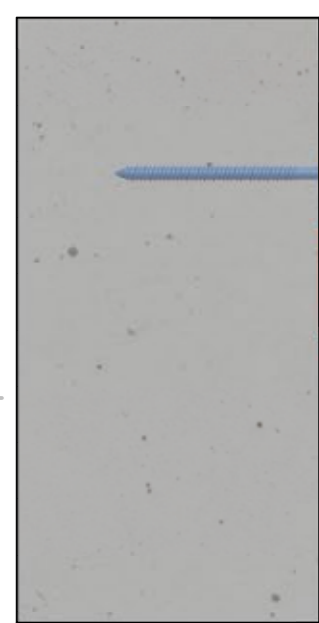
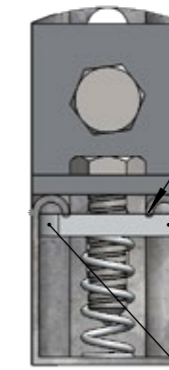

SUITABLE FIREFLY® FIXINGS SECURE THE EXPOSED CHANNEL TO THE WALL AT 500mm CENTRES OR AS REQUIRED TO SUPPORT LOAD

JOINED HORIZONTALLY BY UNISTRUT FRAMEWORK

JOINED HORIZONTALLY BY UNISTRUT FRAMEWORK

38mm FIREFLY® TEK SCREWS SECURE THE CLAMPING CHANNEL TO THE SUPPORTING CHANNEL AT 250mm CENTRES

100mm OVERLAP OF FIREFLY® BARRIER

FIREFLY® HIGH TEMPERATURE ADHESIVE

150mm NOMINAL OVERLAP

SHALLOW CHANNEL CLAMPS THE BARRIER IN PLACE BEFORE BEING WRAPPED WITH THE BARRIER

UNISTRUT FRAMEWORK JOINED TOGETHER WITH MOUNTING BRACKETS

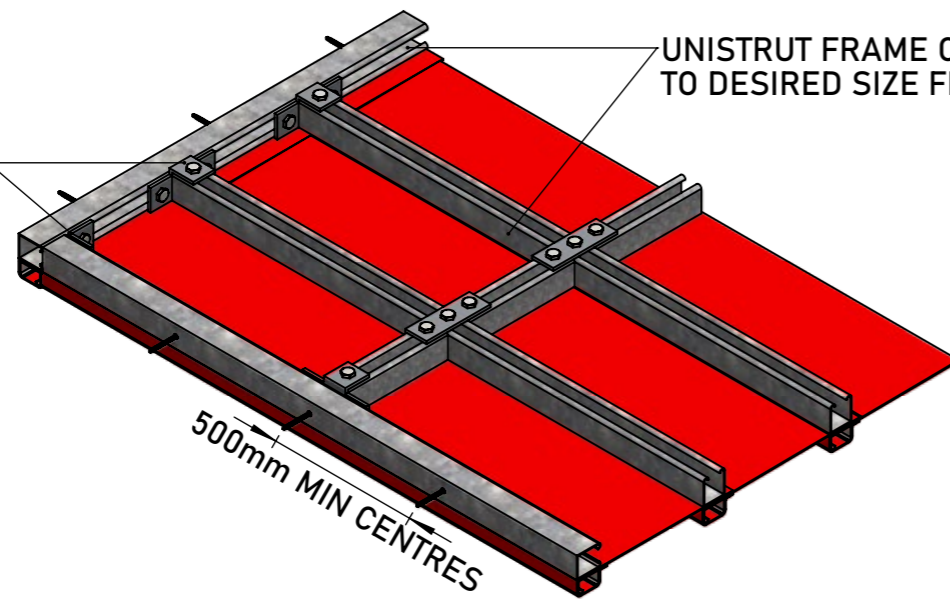

UNISTRUT FRAME CONSTRUCTED TO DESIRED SIZE FIRST

500mm MIN CENTRES

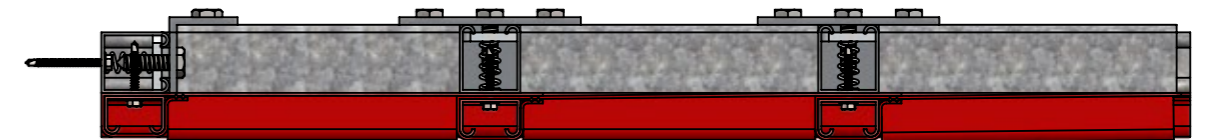

### PHOENIX - CHANNEL EDGE FIX

TBA PROTECTIVE TECHNOLOGIES LTD

Unit 3, Transpennine Trading Estate,  
Gorrells Way Rochdale, OL11 2PX,  
United Kingdom

T: +44 (0)1706 758 817

E: Technical@TBAFIREFLY.COM

W: WWW.TBAFIREFLY.COM

DESIGNER: JC

APPROVED: KG

DATE: 28/08/2023

SCALE: NTS

DRAWING NO:

PH - 103B

REVISION: 2

IN SEQUENCE: 1/1



All rights reserved. No parts of this drawing may be used reproduced, altered, stored in a retrieval system or transmitted in any form or by any means without the prior written permission of tba protective technologies ltd. Whilst every effort has been made to comply with the current statutory regulations, it is the user's responsibility to ensure that the final detailing and installation meets the requirements of relevant regulatory authority (often building control). Please check [www.tbafirefly.com](http://www.tbafirefly.com) to ensure that you are using the correct and current version. Copyright © 2023

DO NOT SCALE. IF IN DOUBT ASK!

A FRAMEWORK IS CONSTRUCTED OUT OF 50 x 50 x 1.2mm MIN THICK GALVANIZED ANGLE, IN SEGMENTS NO LARGER THAN 1070mm x 2000mm

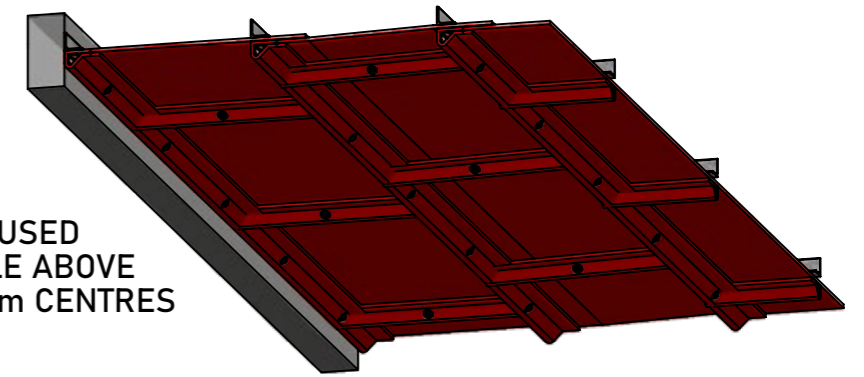
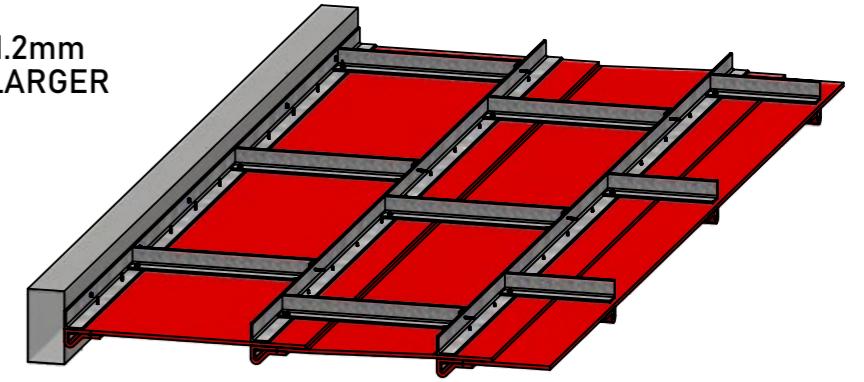
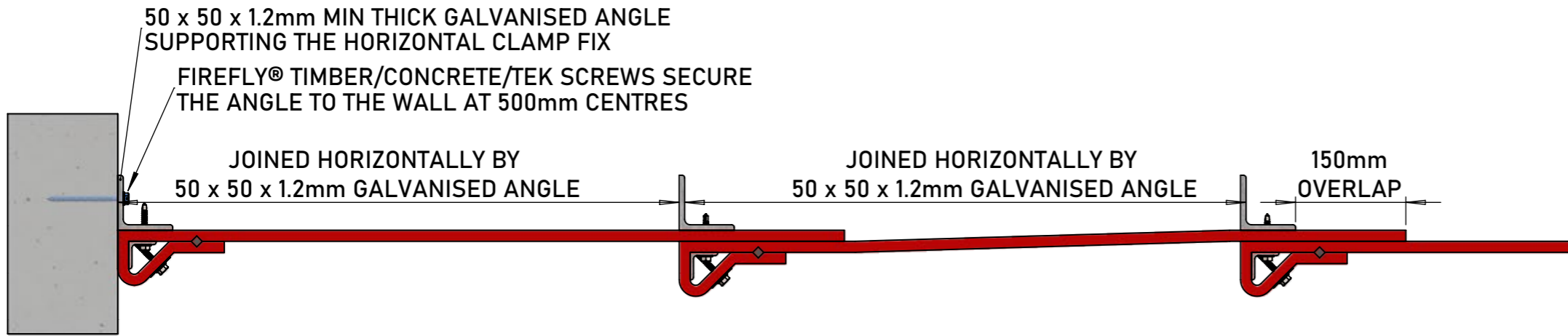

25 x 25 x 0.7mm MIN THICK GALVANISED ANGLE IS USED TO CLAMP THE BARRIER TO THE SUPPORTING ANGLE ABOVE FIXED WITH FIREFLY® 38mm TEK SCREWS AT 250mm CENTRES

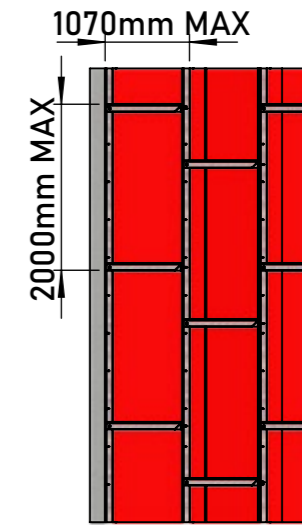
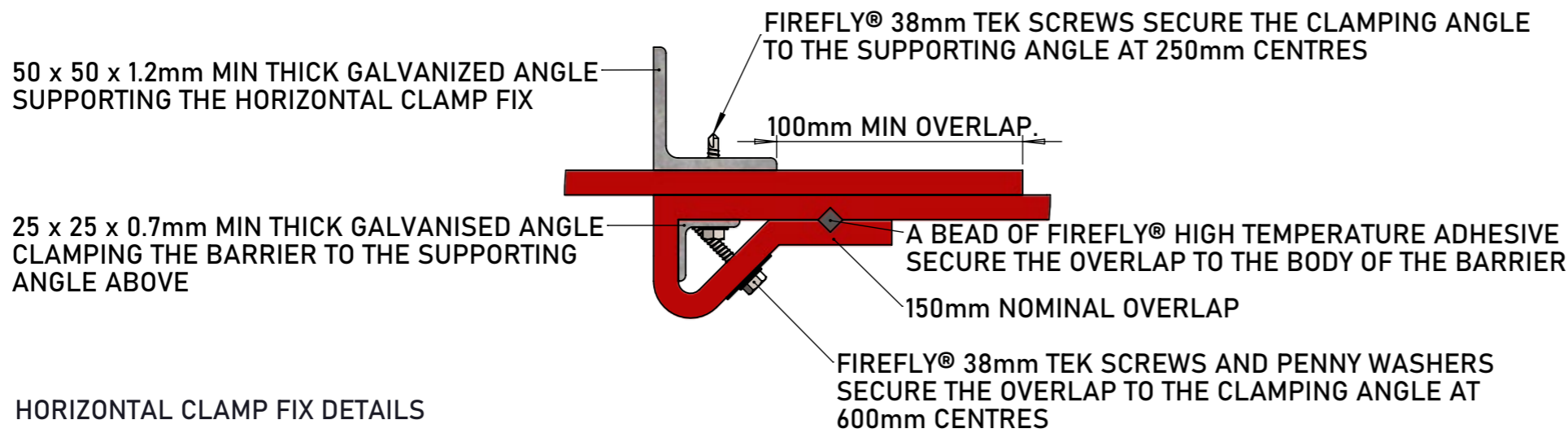

HORIZONTAL FIREFLY BARRIERS MUST BE SUPPORTED EVERY 2000mm x 1070mm

### PHOENIX - EQUAL ANGLE EDGE FIX

TBA PROTECTIVE TECHNOLOGIES LTD  
 Unit 3, Transpennine Trading Estate,  
 Gorrells Way Rochdale, OL11 2PX,  
 United Kingdom  
 T: +44 (0)1706 758 817  
 E: Technical@TBAFIREFLY.com  
 W: WWW.TBAFIREFLY.COM

DESIGNER: JC

DRAWING NO:

APPROVED: KG

PH - 103

DATE: 28/08/2023

REVISION: 2

SCALE: NTS

IN SEQUENCE: 1/1



All rights reserved. No parts of this drawing may be used reproduced, altered, stored in a retrieval system or transmitted in any form or by any means without the prior written permission of tba protective technologies ltd. Whilst every effort has been made to comply with the current statutory regulations, it is the user's responsibility to ensure that the final detailing and installation meets the requirements of relevant regulatory authority (often building control). Please check [www.tbafirefly.com](http://www.tbafirefly.com) to ensure that you are using the correct and current version. Copyright © 2023

DO NOT SCALE. IF IN DOUBT ASK!

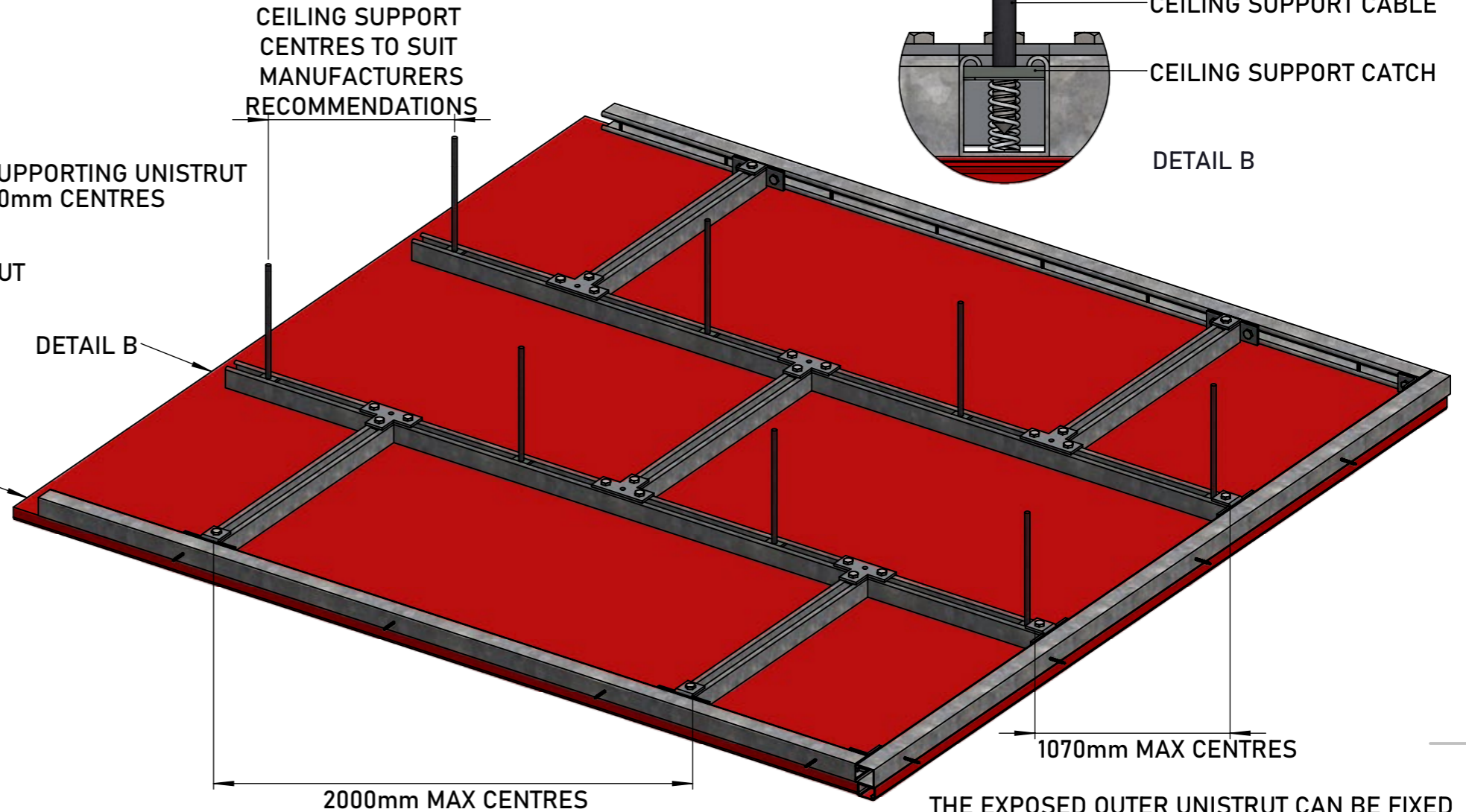
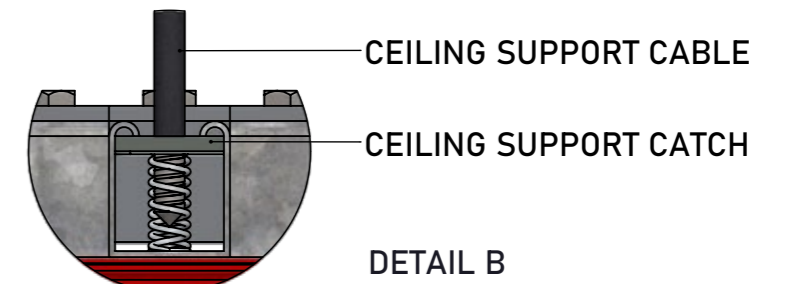
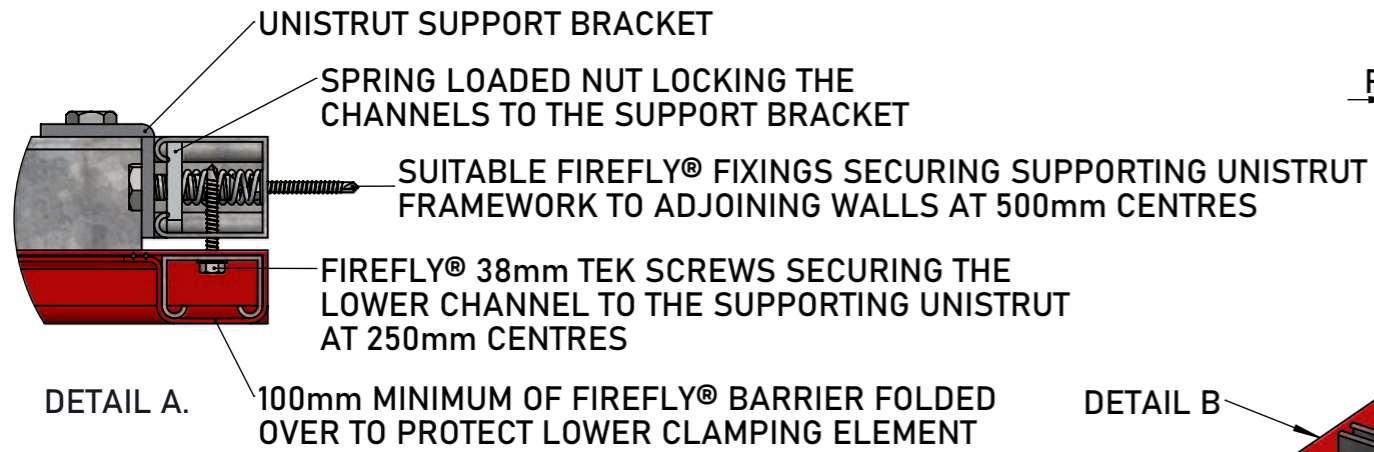

THE EXPOSED OUTER UNISTRUT CAN BE FIXED DIRECTLY INTO ADJOINING WALLS WITH SUITABLE FIREFLY® FIXINGS AT 500mm CENTRES

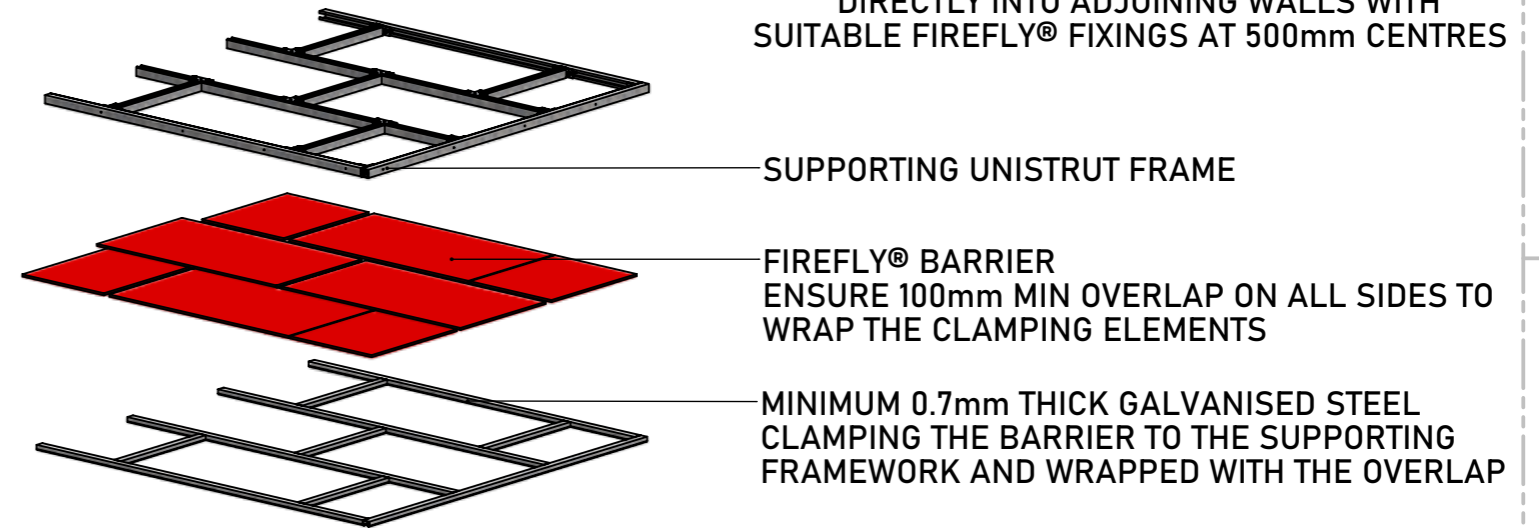
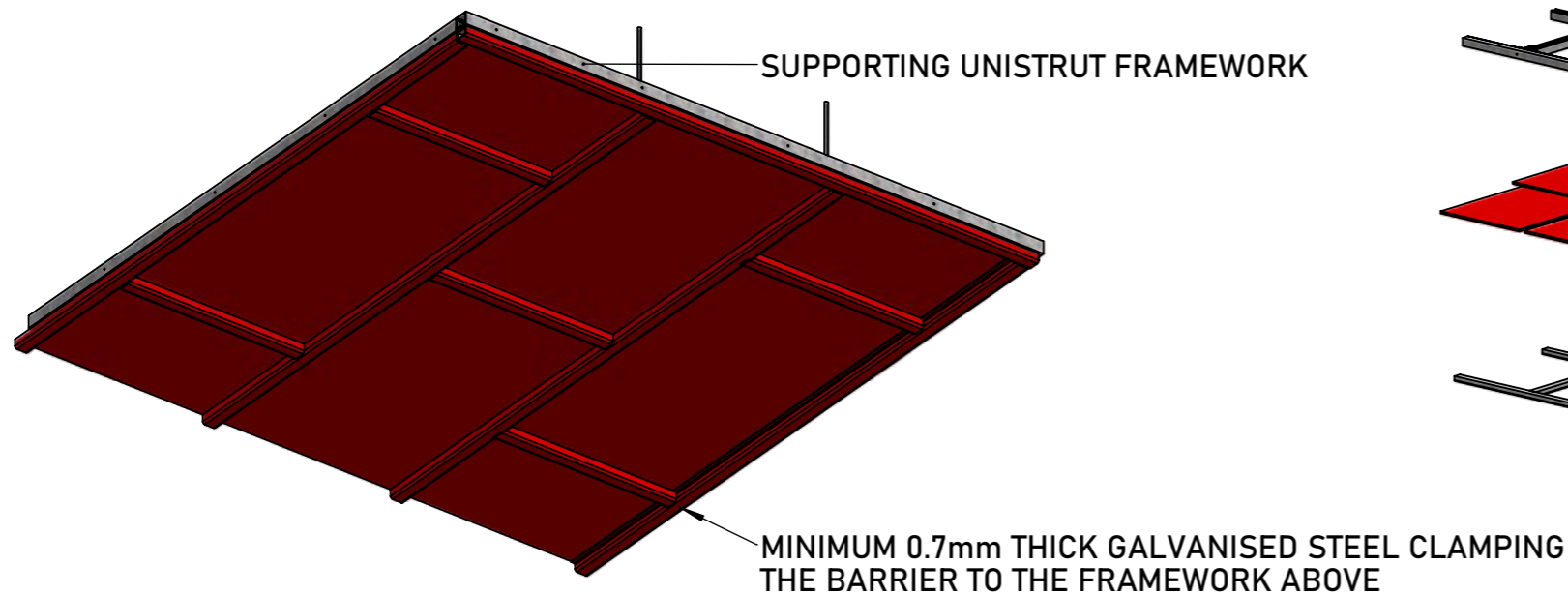

### PHOENIX - SUSPENDED CEILING (CHANNEL)

TBA PROTECTIVE TECHNOLOGIES LTD  
 Unit 3, Transpennine Trading Estate,  
 Gorrells Way Rochdale, OL11 2PX,  
 United Kingdom  
 T: +44 (0)1706 758 817  
 E: Technical@TBAFIREFLY.COM  
 W: WWW.TBAFIREFLY.COM

DESIGNER: JC  
 APPROVED: KG  
 DATE: 28/08/2023  
 SCALE: NTS

DRAWING NO:  
**PH - 104B**  
 REVISION: 2  
 IN SEQUENCE: 1/1

All rights reserved. No parts of this drawing may be used reproduced, altered, stored in a retrieval system or transmitted in any form or by any means without the prior written permission of tba protective technologies ltd. Whilst every effort has been made to comply with the current statutory regulations, it is the user's responsibility to ensure that the final detailing and installation meets the requirements of relevant regulatory authority (often building control). Please check [www.tbafirefly.com](http://www.tbafirefly.com) to ensure that you are using the correct and current version. Copyright © 2023



DO NOT SCALE. IF IN DOUBT ASK!

HORIZONTAL FIREFLY® BARRIER SHOULD BE SUPPORTED BY A CLAMP FIX EVERY 2000mm x 1070mm

TO ACCOMMODATE THIS A FRAMEWORK IS CONSTRUCTED OUT OF 50 x 50 x 1.2mm GALVANISED ANGLE COVERING THE DESIRED AREA AND FIXED INTO THE WALL WITH SUITABLE FIXINGS AT 500mm CENTRES

THE FRAMEWORK IS THEN SEGMENTED WITH 50 x 50 x 1.2mm GALVANISED ANGLE INTO 2m x 1m SEGMENTS SEGMENTS CAN BE STAGGERED TO INCREASE STABILITY

FIREFLY® BARRIER IS CLAMPED TO EACH SEGMENT WITH A 25 x 25 x 0.7mm GALVANISED ANGLE AND A 100mm OVERLAP OF BARRIER EXTENDING INTO THE NEXT CLAMPING ANGLE

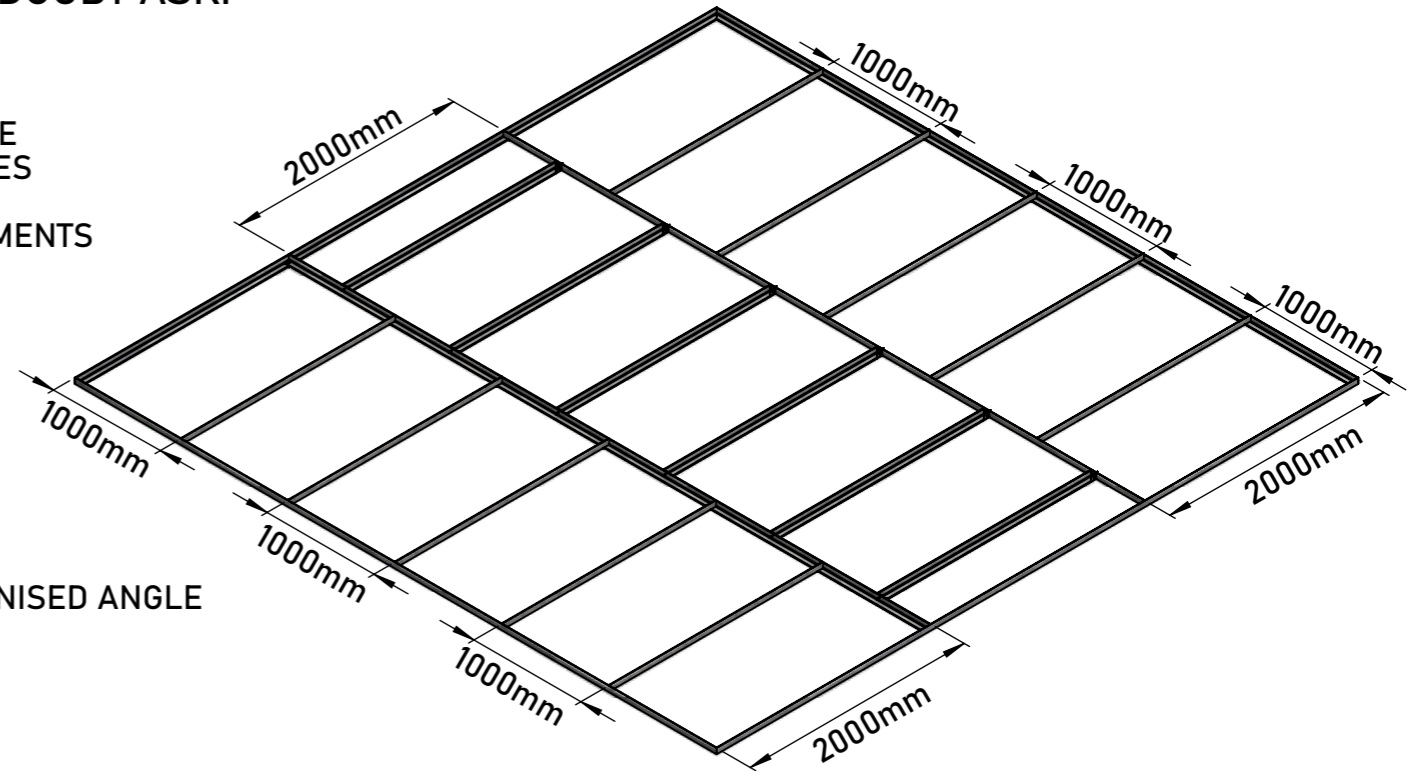

CLAMPING ANGLE DETAIL

SUITABLE TEK SCREWS SECURE THE CLAMPING ANGLE TO THE SUPPORTING ANGLE AT 250mm CENTRES

25 x 25 x 0.7mm MIN THICK GALVANISED ANGLE CLAMPING BARRIER TO THE SUPPORTING ANGLE ABOVE

100mm MIN OVERLAP, 150mm NOMINAL OVERLAP

50 x 50 x 1.2mm MIN THICK GALVANISED ANGLE SUPPORTING THE CLAMP FIX

100mm OVERLAP

A BEAD OF FIREFLY® HIGH TEMPERATURE ADHESIVE SECURE THE OVERLAP TO THE BODY OF THE BARRIER

SUITABLE FIREFLY® TEK SCREWS AND WASHERS SECURE THE OVERLAP TO THE CLAMPING ANGLE AT 600mm CENTRES

FRAMEWORK FIXING DETAILS

THE FRAMEWORK IS CONSTRUCTED BY JOINING THE SUPPORTING ANGLE WITH SUITABLE TEK SCREWS. IF NO SUITABLE FACE FIXING IS AVAILABLE THE ANGLE CAN BE SNIPPED AND BENT TO CREATE A SUITABLE FIXING FACE

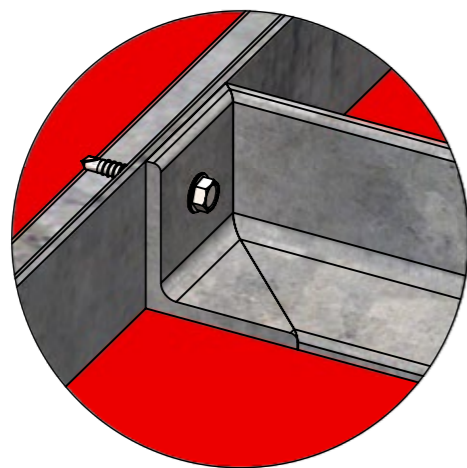

SNIPPED ANGLE FIXING



FLAT ANGLE FIXING

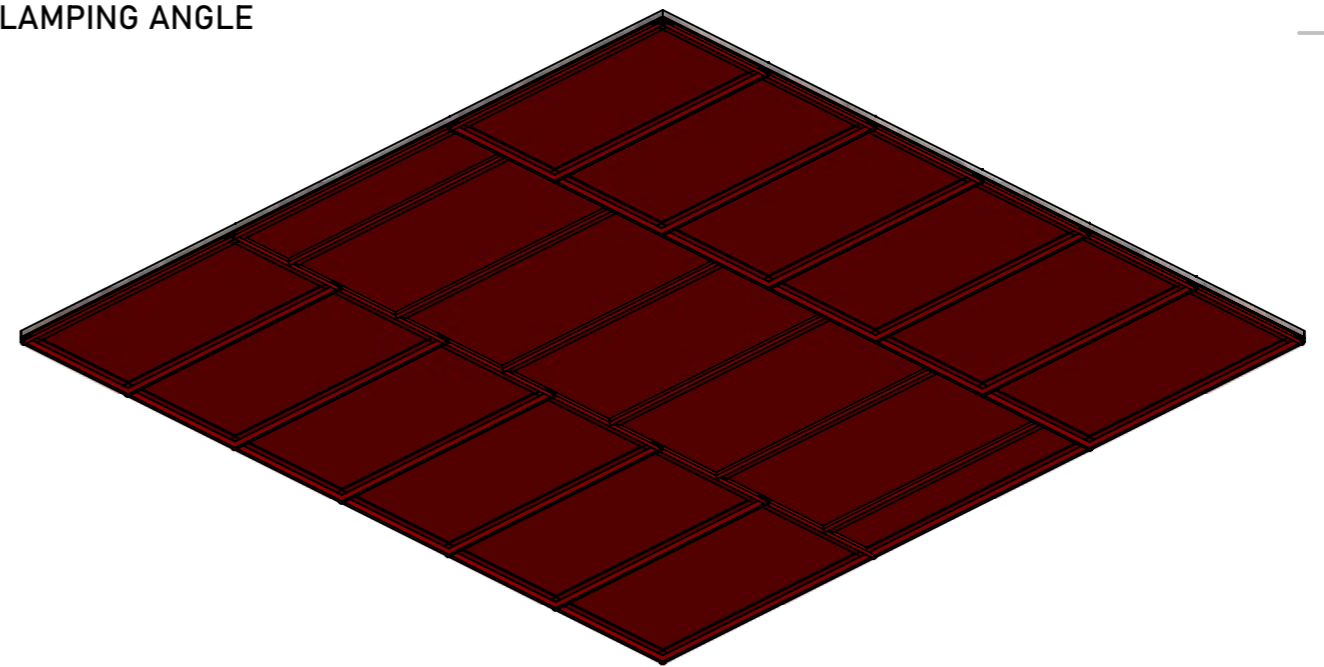

ZEUS LITE - SUSPENDED CEILING

TBA PROTECTIVE TECHNOLOGIES LTD

Unit 3, Transpennine Trading Estate, Gorrells Way Rochdale, OL11 2PX, United Kingdom

T: +44 (0)1706 758 817

E: Technical@TBAFIREFLY.COM

W: WWW.TBAFIREFLY.COM

DESIGNER: JC

APPROVED: KG

DATE: 28/08/2023

SCALE: NTS

DRAWING NO:

PH - 104

REVISION: 2

IN SEQUENCE: 1/1



All rights reserved. No parts of this drawing may be used reproduced, altered, stored in a retrieval system or transmitted in any form or by any means without the prior written permission of tba protective technologies ltd. Whilst every effort has been made to comply with the current statutory regulations, it is the user's responsibility to ensure that the final detailing and installation meets the requirements of relevant regulatory authority (often building control). Please check www.tbafirefly.com to ensure that you are using the correct and current version. Copyright © 2023

HORIZONTAL FIREFLY® BARRIER MUST BE SUPPORTED EVERY 1070mm x 2000mm

FIRESTOPPING MUST EXTEND TO ANY EAVES

DO NOT SCALE. IF IN DOUBT ASK!

PROTECTED ZONE MUST EXTEND 1.5m IN BOTH DIRECTIONS OR 3m IN A SINGLE DIRECTION  
INTERNATIONAL GUIDELINES MAY DIFFER ON PROTECTED ZONES  
IT IS THE INSTALLERS RESPONSIBILITY TO ENSURE LOCAL BUILDING REGULATIONS ARE MET

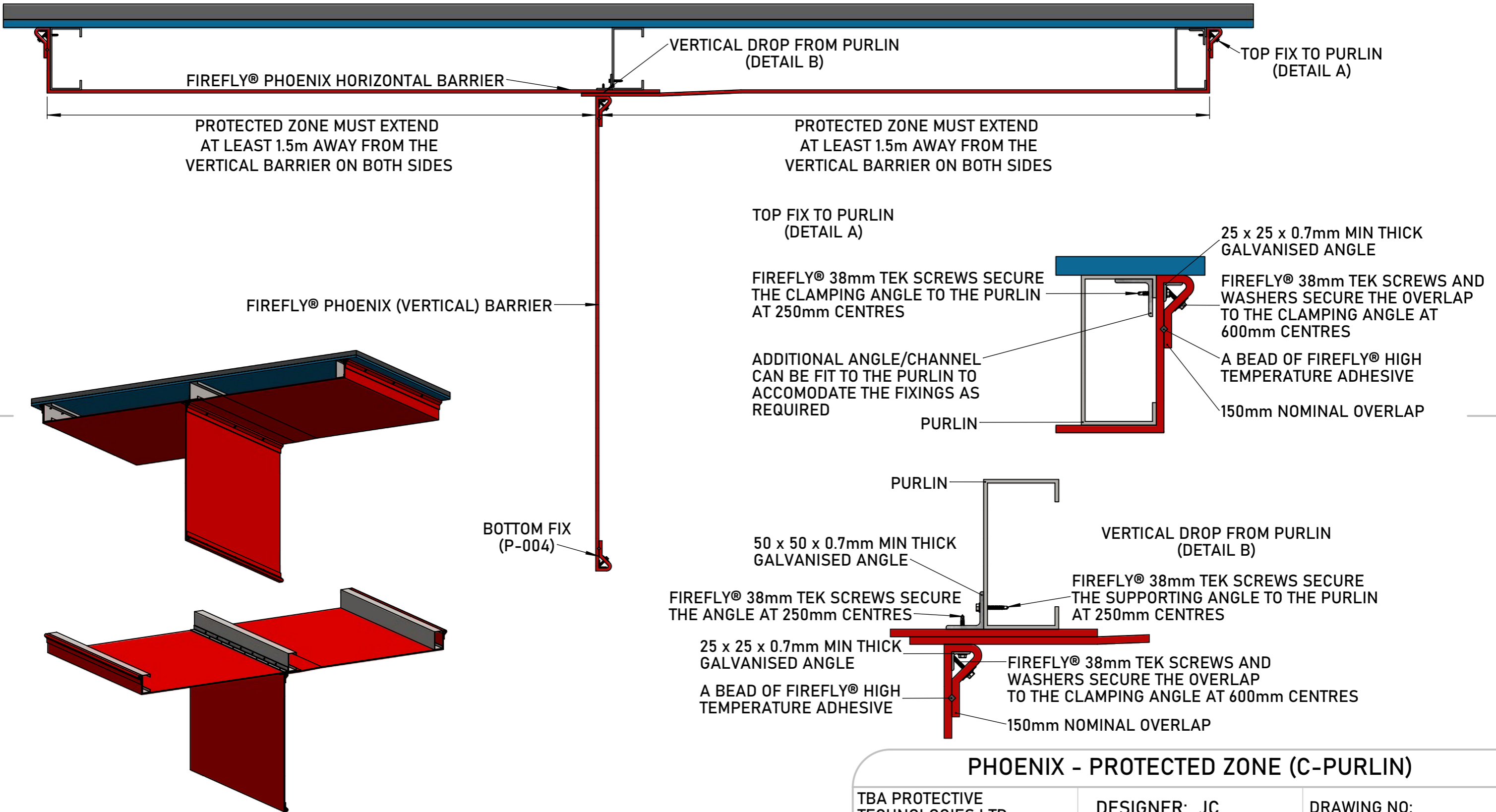

**PHOENIX - PROTECTED ZONE (C-PURLIN)**

<b>TBA PROTECTIVE TECHNOLOGIES LTD</b> Unit 3, Transpennine Trading Estate, Gorrells Way Rochdale, OL11 2PX, United Kingdom T: +44 (0)1706 758 817 E: Technical@TBAFIREFLY.com W: WWW.TBAFIREFLY.COM	DESIGNER: JC	DRAWING NO:
	APPROVED: KG	<b>PH - 105C</b>
	DATE: 28/08/2023	REVISION: 2
	SCALE: NTS	IN SEQUENCE: 1/1



All rights reserved. No parts of this drawing may be used reproduced, altered, stored in a retrieval system or transmitted in any form or by any means without the prior written permission of tba protective technologies ltd. Whilst every effort has been made to comply with the current statutory regulations, it is the user's responsibility to ensure that the final detailing and installation meets the requirements of relevant regulatory authority (often building control). Please check [www.tbafirefly.com](http://www.tbafirefly.com) to ensure that you are using the correct and current version. Copyright © 2023

DO NOT SCALE. IF IN DOUBT ASK!

HORIZONTAL FIREFLY® BARRIER MUST BE SUPPORTED EVERY 1070mm x 2000mm

PROTECTED ZONE MUST EXTEND 1.5m IN BOTH DIRECTIONS OR 3m IN A SINGLE DIRECTION  
INTERNATIONAL GUIDELINES MAY DIFFER ON PROTECTED ZONES  
IT IS THE INSTALLERS RESPONSIBILITY TO ENSURE LOCAL BUILDING REGULATIONS ARE MET

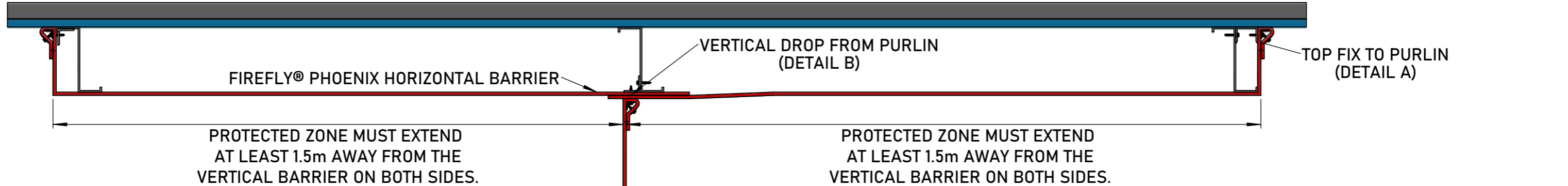

PROTECTED ZONE MUST EXTEND AT LEAST 1.5m AWAY FROM THE VERTICAL BARRIER ON BOTH SIDES.

PROTECTED ZONE MUST EXTEND AT LEAST 1.5m AWAY FROM THE VERTICAL BARRIER ON BOTH SIDES.

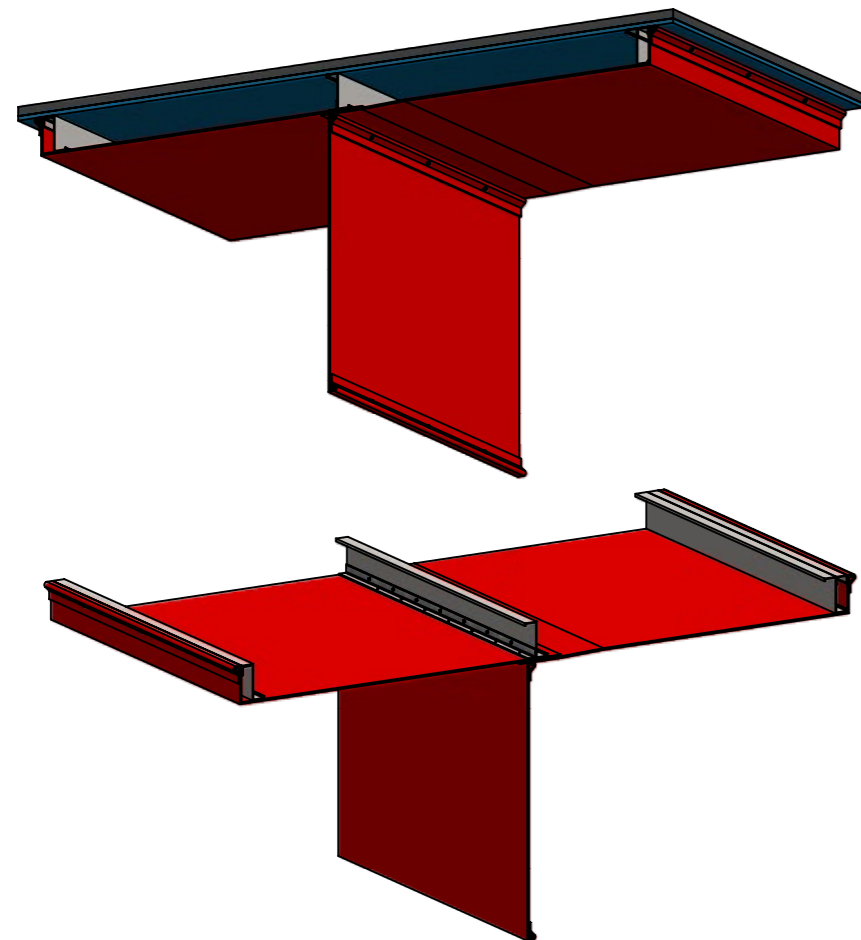

TOP FIX TO PURLIN (DETAIL A)

ADDITIONAL ANGLE/CHANNEL CAN BE FIT TO THE PURLIN TO ACCOMODATE THE FIXINGS AS REQUIRED

FIREFLY® 38mm TEK SCREWS SECURE THE CLAMPING ANGLE TO THE PURLIN AT 250mm CENTRES

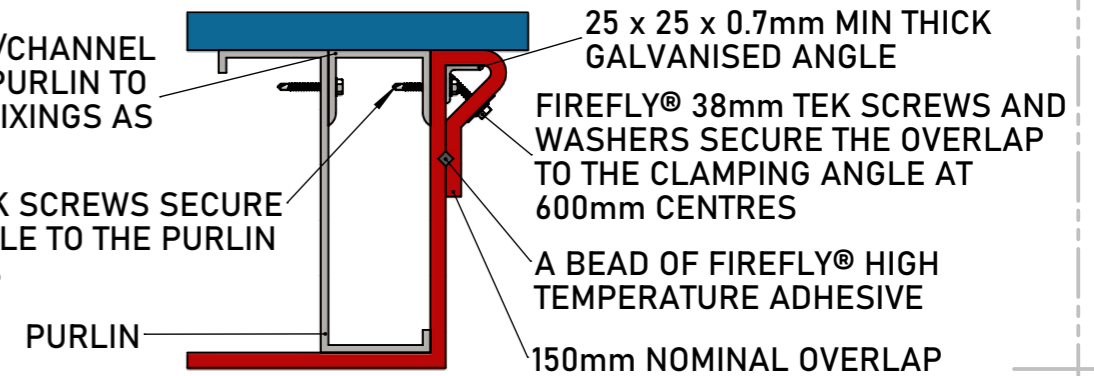

BOTTOM FIX (P-004)

50 x 50 x 0.7mm MIN THICK GALVANISED ANGLE

FIREFLY® 38mm TEK SCREWS SECURE THE ANGLE AT 250mm CENTRES

25 x 25 x 0.7mm MIN THICK GALVANISED ANGLE

A BEAD OF FIREFLY® HIGH TEMPERATURE ADHESIVE

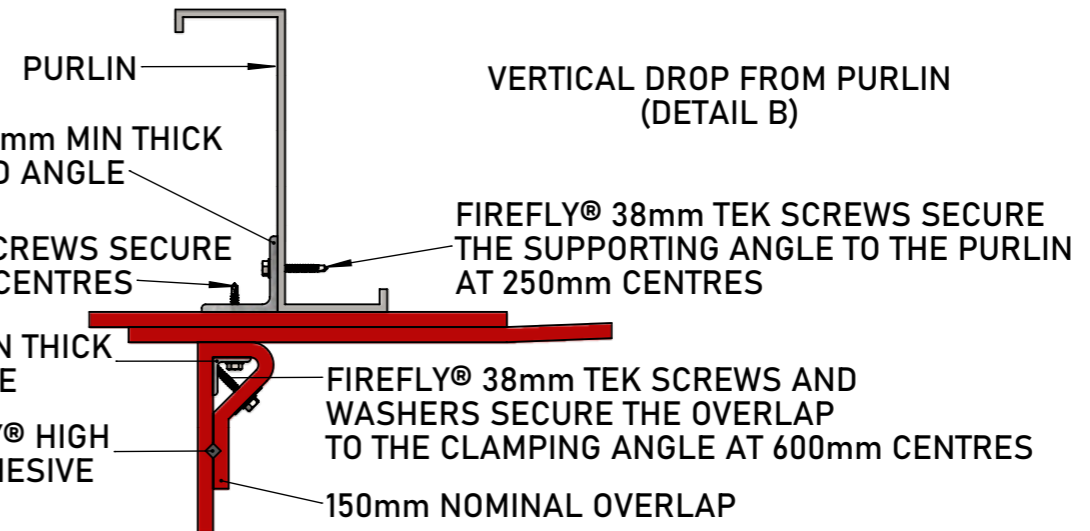

PHOENIX - PROTECTED ZONE (Z-PURLIN)

TBA PROTECTIVE TECHNOLOGIES LTD Unit 3, Transpennine Trading Estate, Gorrells Way Rochdale, OL11 2PX, United Kingdom T: +44 (0)1706 758 817 E: Technical@TBAFIREFLY.com W: WWW.TBAFIREFLY.COM	DESIGNER: JC	DRAWING NO:
	APPROVED: KG	PH - 105Z
	DATE: 28/08/2023	REVISION: 1
	SCALE: NTS	IN SEQUENCE: 1/1

All rights reserved. No parts of this drawing may be used reproduced, altered, stored in a retrieval system or transmitted in any form or by any means without the prior written permission of tba protective technologies ltd. Whilst every effort has been made to comply with the current statutory regulations, it is the user's responsibility to ensure that the final detailing and installation meets the requirements of relevant regulatory authority (often building control). Please check [www.tbafirefly.com](http://www.tbafirefly.com) to ensure that you are using the correct and current version. Copyright © 2023



DO NOT SCALE. IF IN DOUBT ASK!

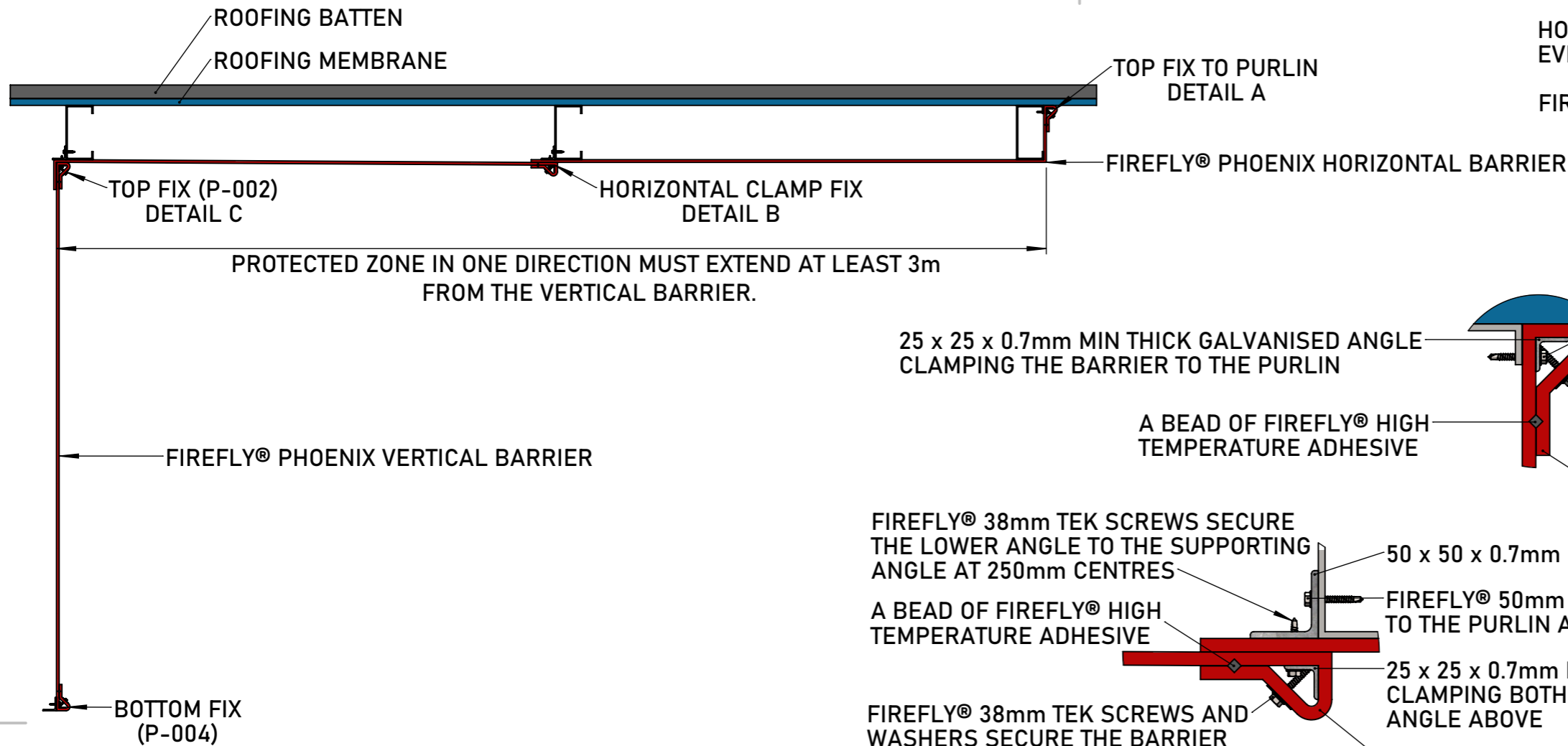

HORIZONTAL FIREFLY® BARRIER MUST BE SUPPORTED EVERY 1070mm x 2000mm  
FIRESTOPPING MUST EXTEND TO ANY EAVES

DETAIL A  
TOP FIX TO TIMBER

25 x 25 x 0.7mm MIN THICK GALVANISED ANGLE CLAMPING THE BARRIER TO THE PURLIN

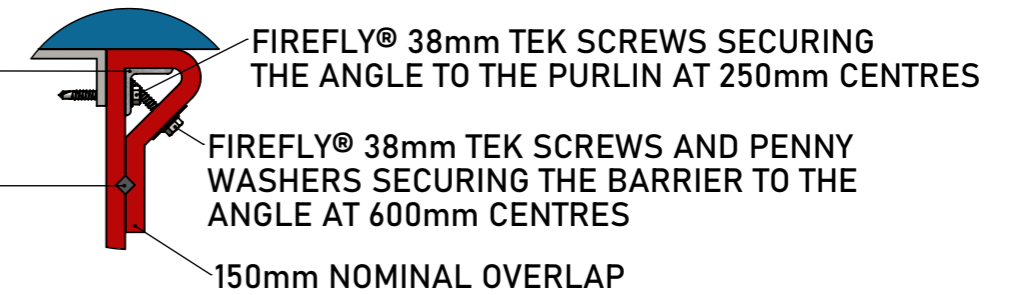

A BEAD OF FIREFLY® HIGH TEMPERATURE ADHESIVE

FIREFLY® 38mm TEK SCREWS SECURE THE LOWER ANGLE TO THE SUPPORTING ANGLE AT 250mm CENTRES

A BEAD OF FIREFLY® HIGH TEMPERATURE ADHESIVE

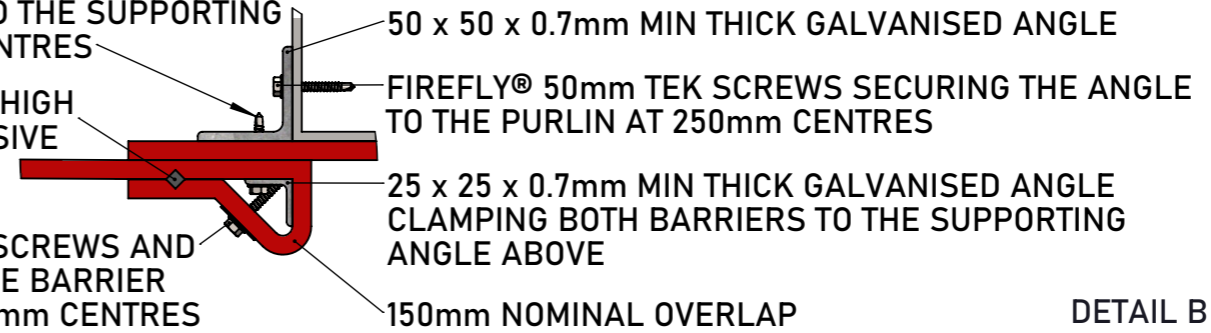

DETAIL B  
HORIZONTAL CLAMP FIX

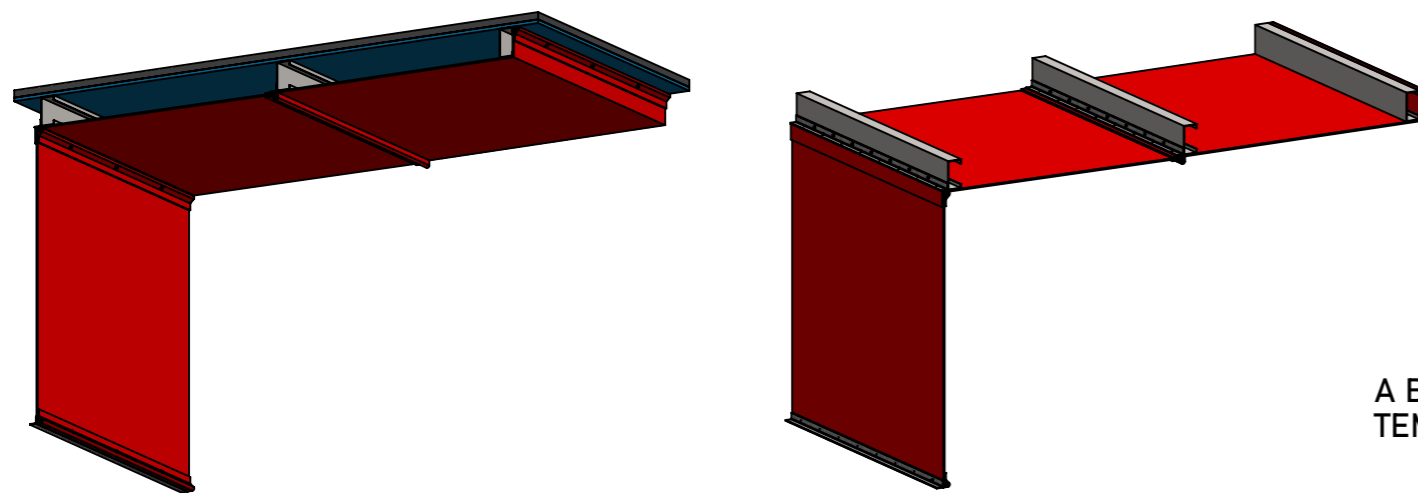

DETAIL C  
TOP FIX

A BEAD OF FIREFLY® HIGH TEMPERATURE ADHESIVE

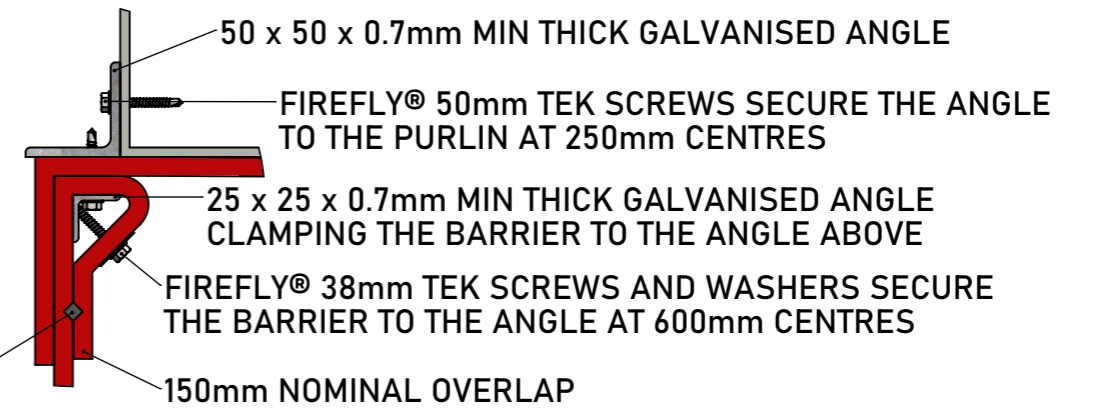

PHOENIX - RESTRICTED ACCESS PROTECTED ZONE

TBA PROTECTIVE TECHNOLOGIES LTD Unit 3, Transpennine Trading Estate, Gorrells Way Rochdale, OL11 2PX, United Kingdom T: +44 (0)1706 758 817 E: Technical@TBAFIREFLY.com W: WWW.TBAFIREFLY.COM	DESIGNER: JC	DRAWING NO:
	APPROVED: KG	PH - 106C
	DATE: 28/08/2023	REVISION: 2
	SCALE: NTS	IN SEQUENCE: 1/1

PROTECTED ZONE MUST EXTEND 1.5m IN BOTH DIRECTIONS OR 3m IN A SINGLE DIRECTION  
INTERNATIONAL GUIDELINES MAY DIFFER ON PROTECTED ZONES  
IT IS THE INSTALLERS RESPONSIBILITY TO ENSURE LOCAL BUILDING REGULATIONS ARE MET



All rights reserved. No parts of this drawing may be used reproduced, altered, stored in a retrieval system or transmitted in any form or by any means without the prior written permission of tba protective technologies ltd. Whilst every effort has been made to comply with the current statutory regulations, it is the user's responsibility to ensure that the final detailing and installation meets the requirements of relevant regulatory authority (often building control). Please check www.tbafirefly.com to ensure that you are using the correct and current version. Copyright © 2023

DO NOT SCALE. IF IN DOUBT ASK!

HORIZONTAL FIREFLY® BARRIER MUST BE SUPPORTED EVERY 1070mm x 2000mm

FIRESTOPPING MUST EXTEND TO ANY EAVES

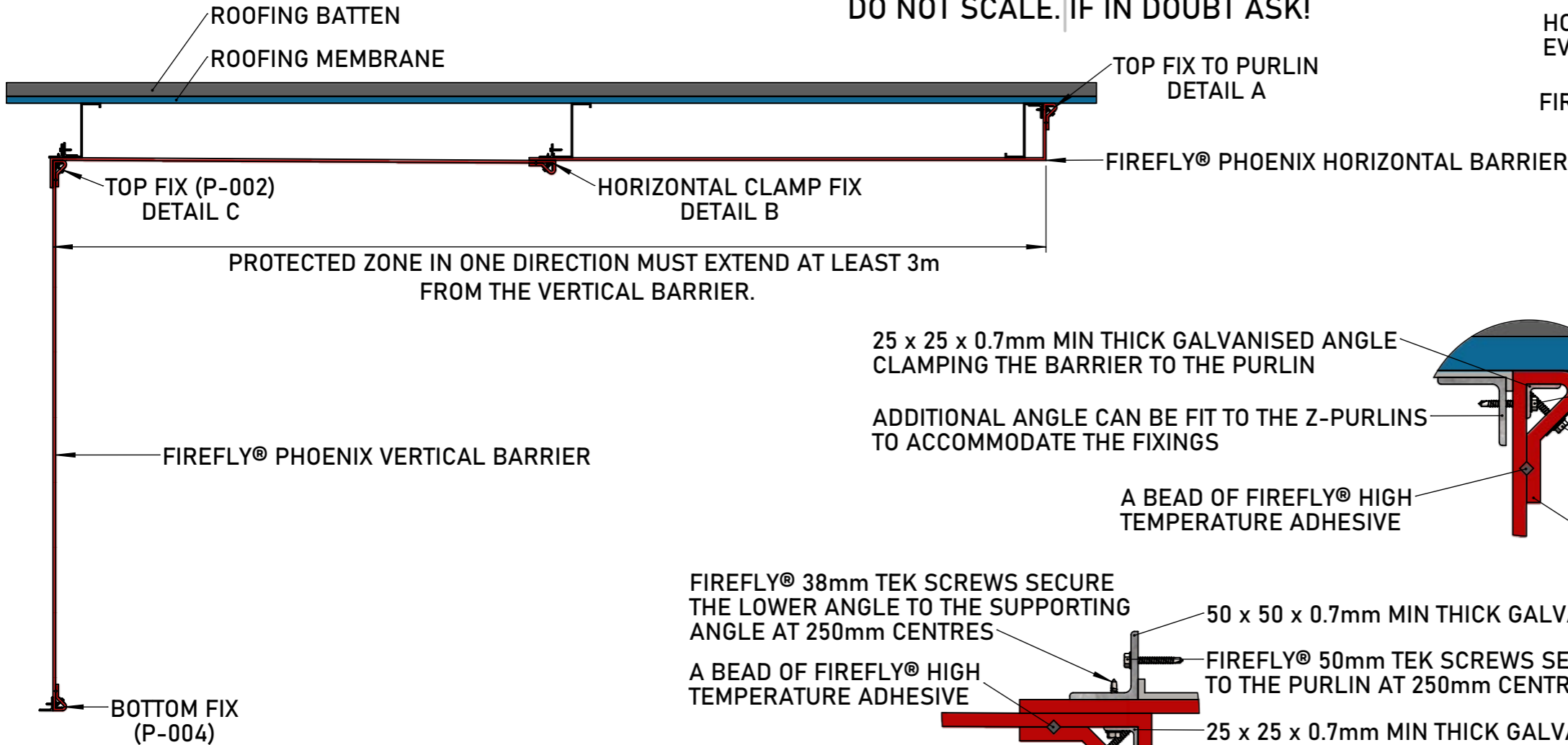

25 x 25 x 0.7mm MIN THICK GALVANISED ANGLE CLAMPING THE BARRIER TO THE PURLIN  
 ADDITIONAL ANGLE CAN BE FIT TO THE Z-PURLINS TO ACCOMMODATE THE FIXINGS

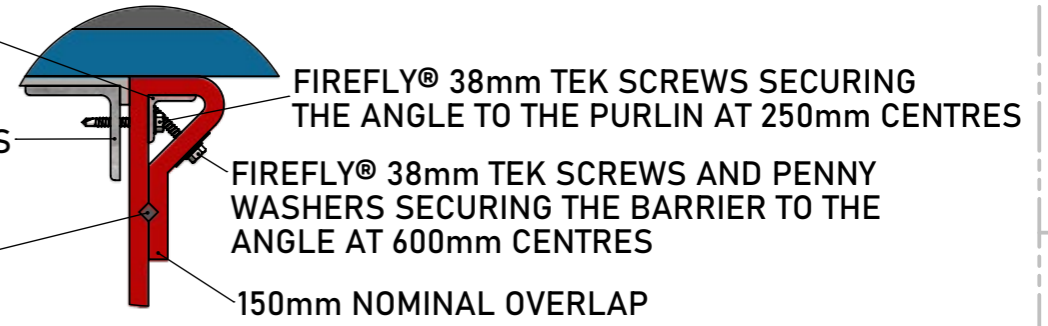

FIREFLY® 38mm TEK SCREWS SECURE THE LOWER ANGLE TO THE SUPPORTING ANGLE AT 250mm CENTRES

A BEAD OF FIREFLY® HIGH TEMPERATURE ADHESIVE

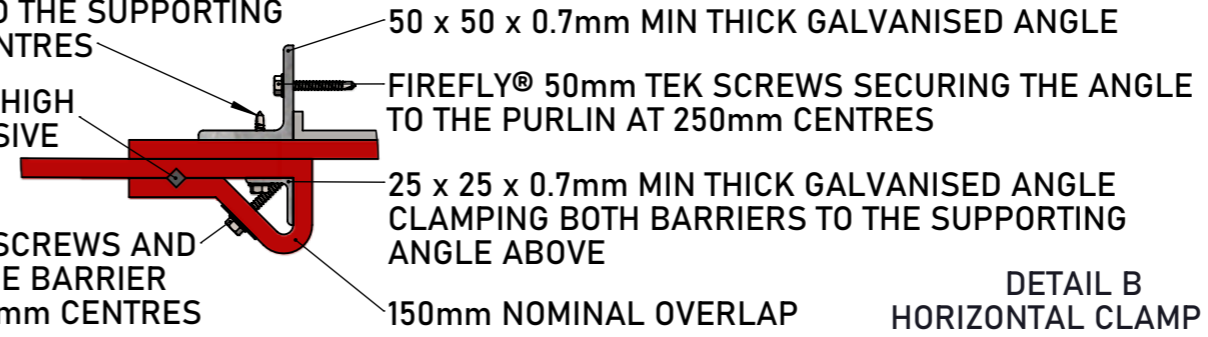

FIREFLY® 38mm TEK SCREWS AND WASHERS SECURE THE BARRIER TO THE ANGLE AT 600mm CENTRES

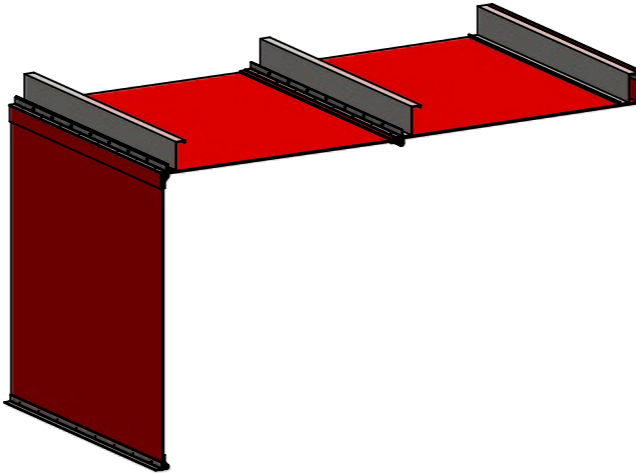
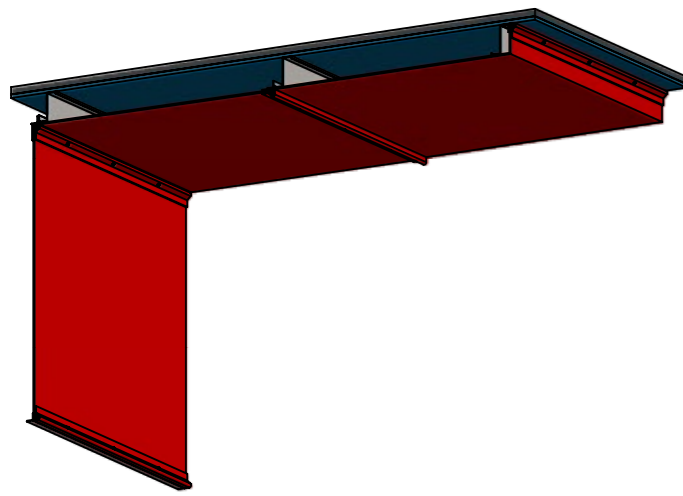

ADDITIONAL ANGLE CAN BE FIT TO THE Z-PURLINS TO ACCOMMODATE THE FIXINGS



A BEAD OF FIREFLY® HIGH TEMPERATURE ADHESIVE

PROTECTED ZONE MUST EXTEND 1.5m IN BOTH DIRECTIONS OR 3m IN A SINGLE DIRECTION  
 INTERNATIONAL GUIDELINES MAY DIFFER ON PROTECTED ZONES  
 IT IS THE INSTALLERS RESPONSIBILITY TO ENSURE LOCAL BUILDING REGULATIONS ARE MET



All rights reserved. No parts of this drawing may be used reproduced, altered, stored in a retrieval system or transmitted in any form or by any means without the prior written permission of tba protective technologies ltd. Whilst every effort has been made to comply with the current statutory regulations, it is the user's responsibility to ensure that the final detailing and installation meets the requirements of relevant regulatory authority (often building control). Please check www.tbafirefly.com to ensure that you are using the correct and current version. Copyright © 2023

ZEUS LITE - RESTRICTED ACCESS PROTECTED ZONE

TBA PROTECTIVE TECHNOLOGIES LTD Unit 3, Transpennine Trading Estate, Gorrells Way Rochdale, OL11 2PX, United Kingdom T: +44 (0)1706 758 817 E: Technical@TBAFIREFLY.com W: WWW.TBAFIREFLY.COM	DESIGNER: JC	DRAWING NO:
	APPROVED: KG	PH - 106Z
	DATE: 28/08/2023	REVISION: 2
	SCALE: NTS	IN SEQUENCE: 1/1

DO NOT SCALE. IF IN DOUBT ASK!

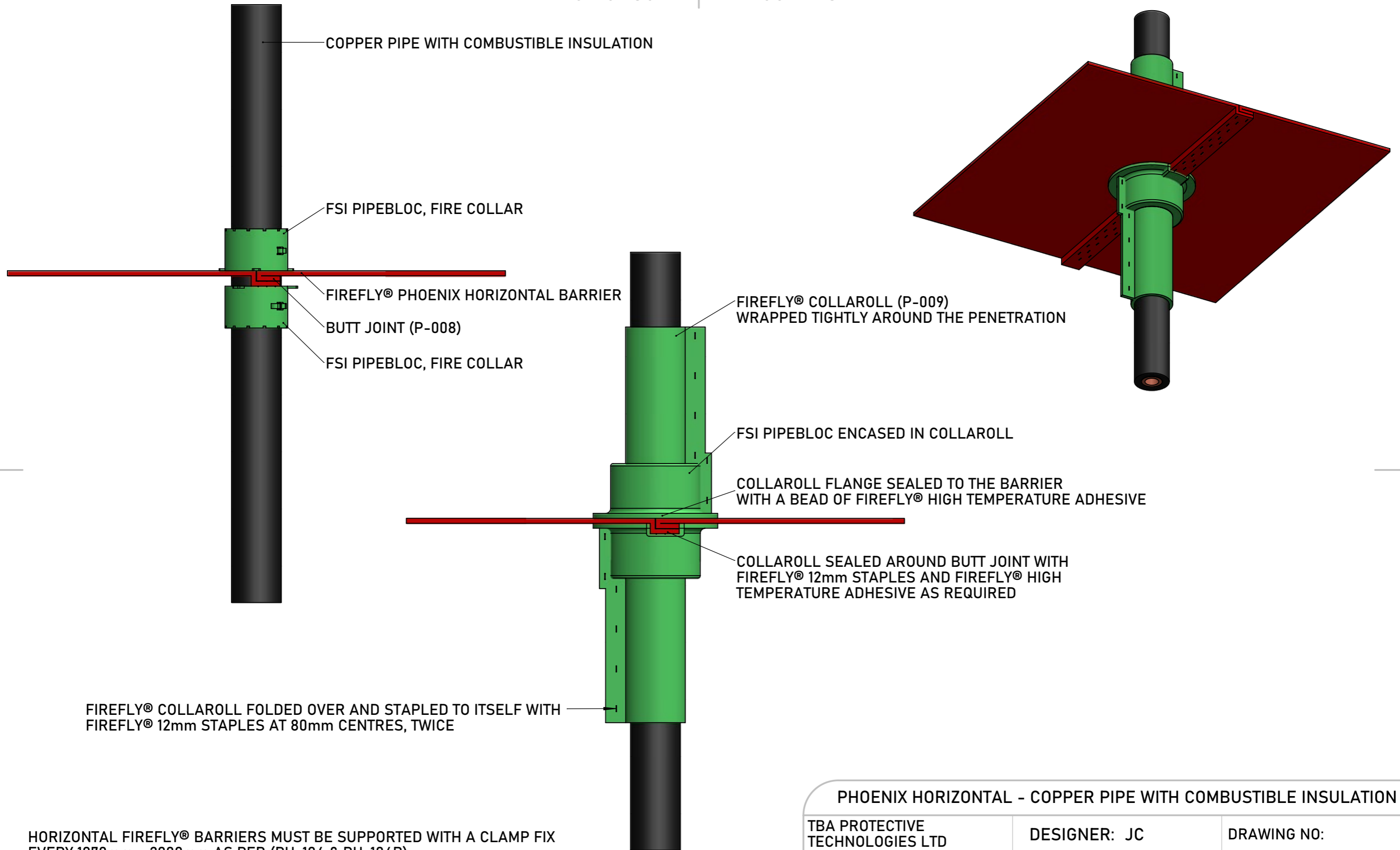

FIREFLY® COLLAROLL FOLDED OVER AND STAPLED TO ITSELF WITH FIREFLY® 12mm STAPLES AT 80mm CENTRES, TWICE

HORIZONTAL FIREFLY® BARRIERS MUST BE SUPPORTED WITH A CLAMP FIX EVERY 1070mm x 2000mm AS PER (PH-104 & PH-104B)

PHOENIX HORIZONTAL - COPPER PIPE WITH COMBUSTIBLE INSULATION

TBA PROTECTIVE TECHNOLOGIES LTD

Unit 3, Transpennine Trading Estate,  
Gorrells Way Rochdale, OL11 2PX,  
United Kingdom

T: +44 (0)1706 758 817

E: Technical@TBAFIREFLY.COM

W: WWW.TBAFIREFLY.COM

DESIGNER: JC

APPROVED: KG

DATE: 13/09/2024

SCALE: NTS

DRAWING NO:

PH - 151

REVISION: 1

IN SEQUENCE: 1/1

All rights reserved. No parts of this drawing may be used reproduced, altered, stored in a retrieval system or transmitted in any form or by any means without the prior written permission of tba protective technologies ltd. Whilst every effort has been made to comply with the current statutory regulations, it is the user's responsibility to ensure that the final detailing and installation meets the requirements of relevant regulatory authority (often building control). Please check www.tbafirefly.com to ensure that you are using the correct and current version. Copyright © 2023



DO NOT SCALE. IF IN DOUBT ASK!

HORIZONTAL FIREFLY® BARRIERS MUST BE SUPPORTED WITH A CLAMP FIX EVERY 1070mm x 2000mm AS PER (PH-104 & PH-104B)

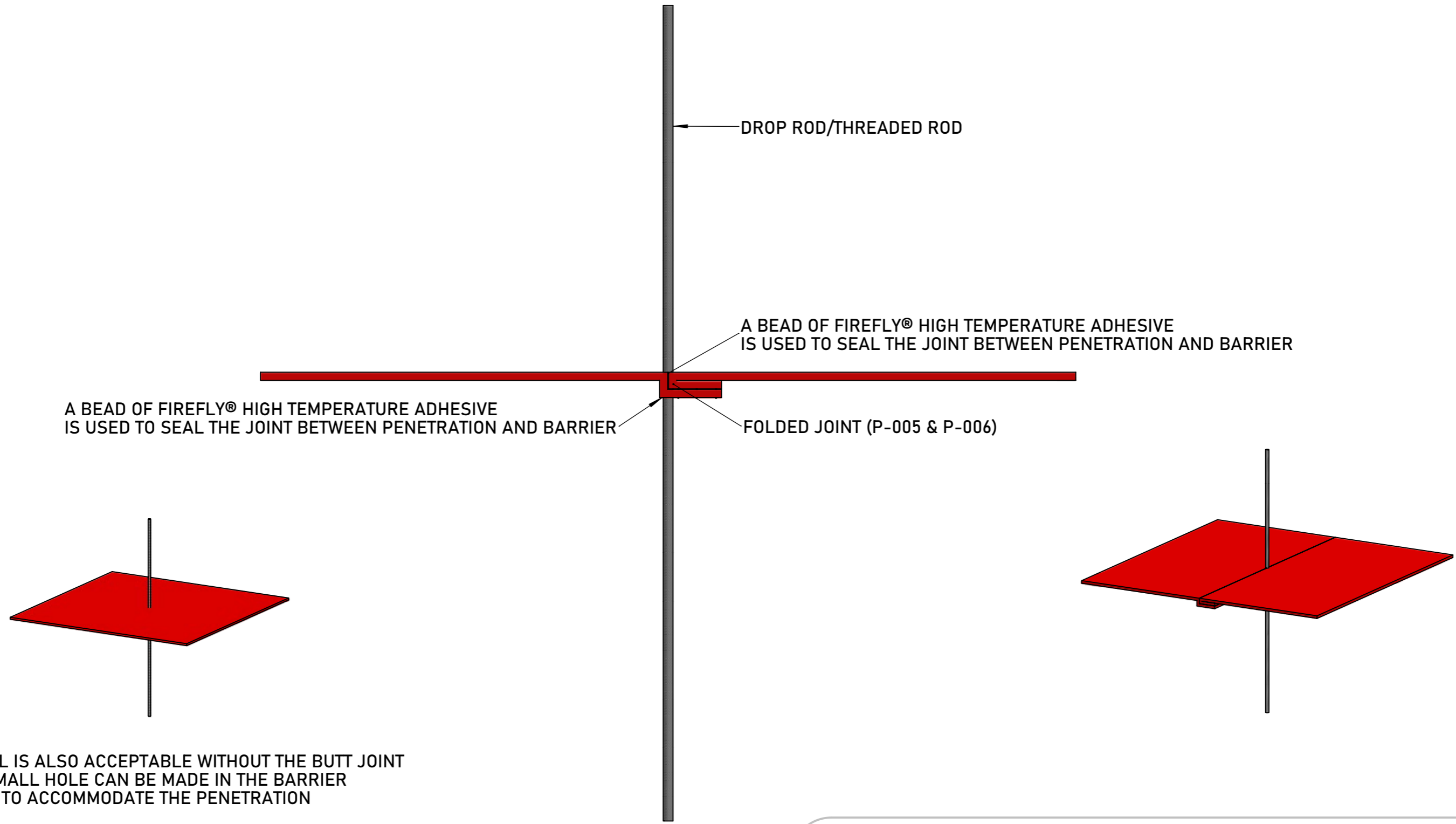

THIS DETAIL IS ALSO ACCEPTABLE WITHOUT THE BUTT JOINT  
A SMALL HOLE CAN BE MADE IN THE BARRIER  
TO ACCOMMODATE THE PENETRATION

### PHOENIX HORIZONTAL - THREADED DROP ROD

TBA PROTECTIVE TECHNOLOGIES LTD  
 Unit 3, Transpennine Trading Estate,  
 Gorrells Way Rochdale, OL11 2PX,  
 United Kingdom  
 T: +44 (0)1706 758 817  
 E: Technical@TBAFIREFLY.COM  
 W: WWW.TBAFIREFLY.COM

DESIGNER: JC	DRAWING NO:
APPROVED: KG	PH - 152
DATE: 19/09/2024	REVISION: 2
SCALE: NTS	IN SEQUENCE: 1/1

All rights reserved. No parts of this drawing may be used reproduced, altered, stored in a retrieval system or transmitted in any form or by any means without the prior written permission of tba protective technologies ltd. Whilst every effort has been made to comply with the current statutory regulations, it is the user's responsibility to ensure that the final detailing and installation meets the requirements of relevant regulatory authority (often building control). Please check [www.tbafirefly.com](http://www.tbafirefly.com) to ensure that you are using the correct and current version. Copyright © 2023



DO NOT SCALE. IF IN DOUBT ASK!

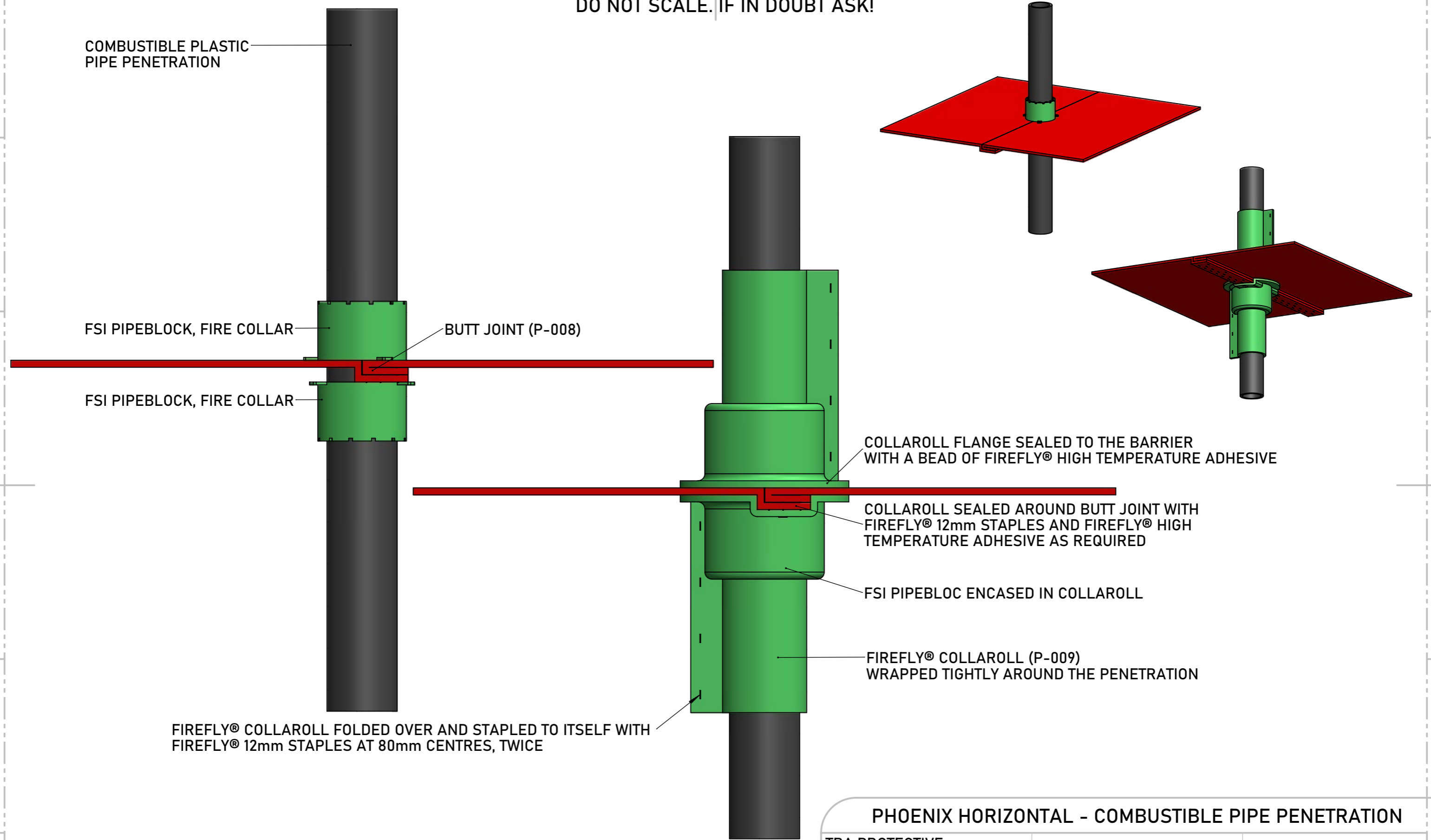

HORIZONTAL FIREFLY® BARRIERS MUST BE SUPPORTED WITH A CLAMP FIX EVERY 1070mm x 2000mm AS PER (PH-104 & PH-104B)



All rights reserved. No parts of this drawing may be used reproduced, altered, stored in a retrieval system or transmitted in any form or by any means without the prior written permission of tba protective technologies ltd. Whilst every effort has been made to comply with the current statutory regulations, it is the user's responsibility to ensure that the final detailing and installation meets the requirements of relevant regulatory authority (often building control). Please check [www.tbafirefly.com](http://www.tbafirefly.com) to ensure that you are using the correct and current version. Copyright © 2023

PHOENIX HORIZONTAL - COMBUSTIBLE PIPE PENETRATION

TBA PROTECTIVE TECHNOLOGIES LTD Unit 3, Transpennine Trading Estate, Gorrells Way Rochdale, OL11 2PX, United Kingdom T: +44 (0)1706 758 817 E: Technical@TBAFIREFLY.COM W: WWW.TBAFIREFLY.COM	DESIGNER: JC	DRAWING NO:
	APPROVED: KG	PH - 153
	DATE: 13/09/2024	REVISION: 1
	SCALE: NTS	IN SEQUENCE: 1/1

DO NOT SCALE. IF IN DOUBT ASK!

THERE IS A WIDE VARIETY OF FIXING AND INSTALLATION METHODS AVAILABLE FOR THE UNISTRUT SYSTEM  
 THESE INSTRUCTIONS ARE INTENDED FOR FRAMEWORK AND SUPPORT OF THE FIREFLY® BARRIER SYSTEM ONLY  
 FOR MORE BESPOKE PROJECTS PLEASE CONTACT OUR TECHNICAL TEAM FOR ADVICE

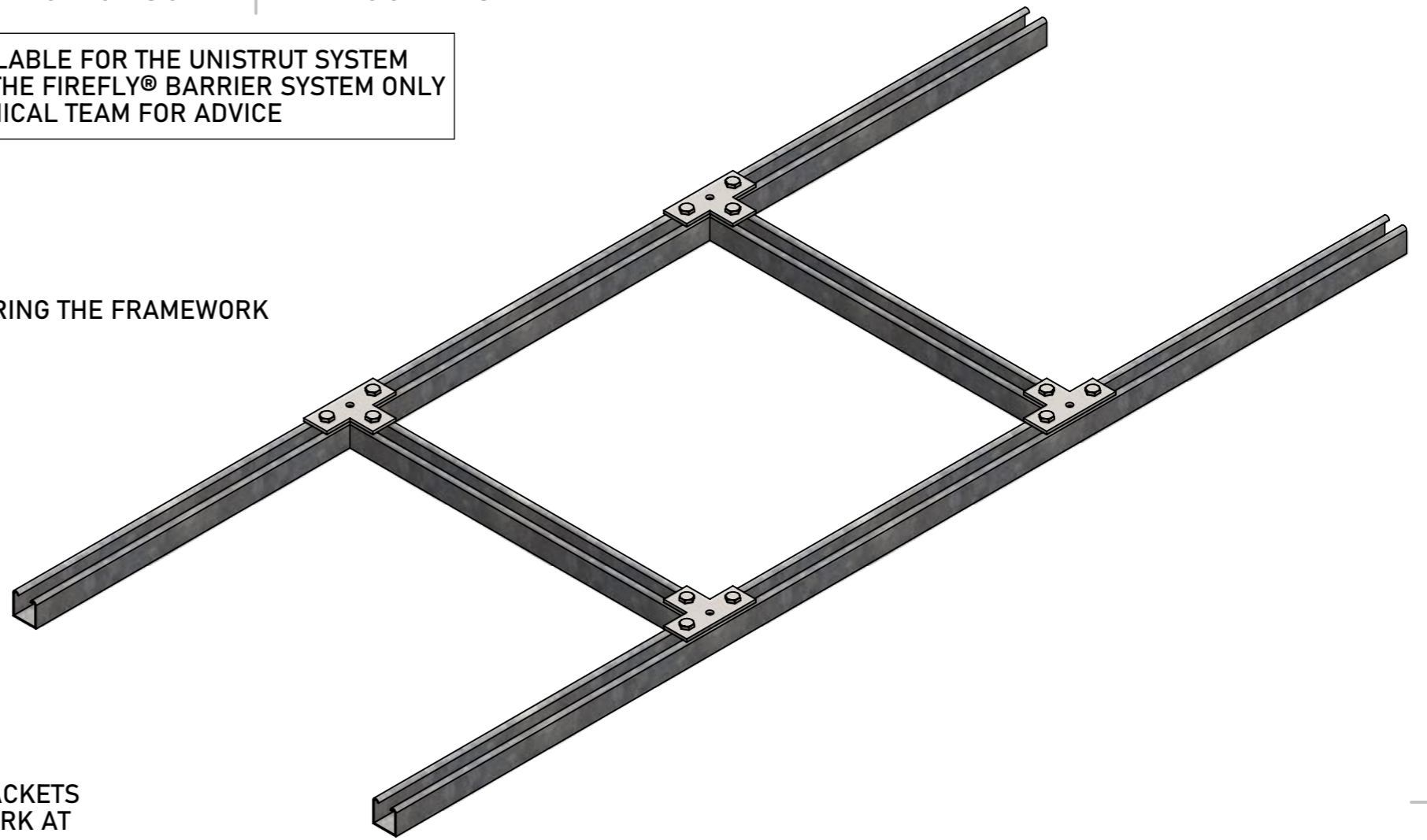
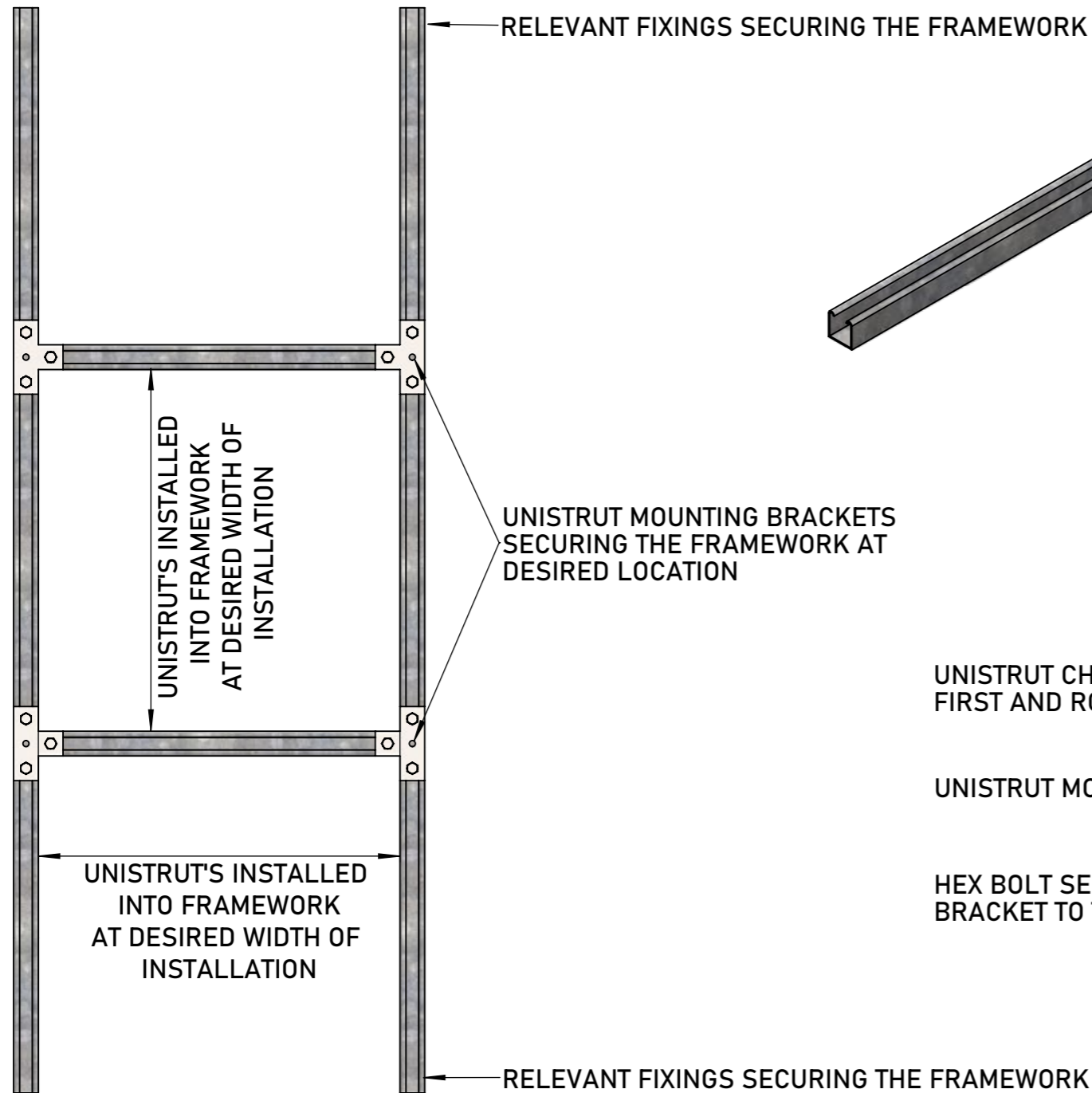

JOINING UNISTRUT'S

UNISTRUT CHANNEL NUT WITH SPRING INSERTED FIRST AND ROTATED TO LOCK POSITION

UNISTRUT MOUNTING BRACKET

HEX BOLT SECURING THE MOUNTING BRACKET TO THE NUT

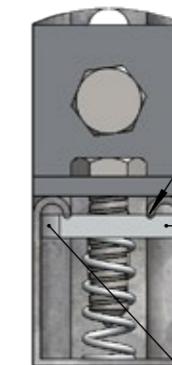
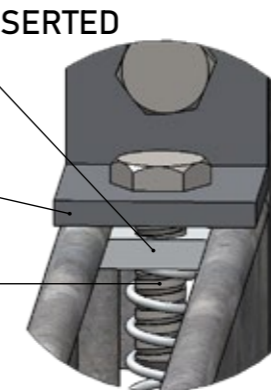

THE LIP OF THE UNISTRUT SLOTS INTO THE GROOVE OF THE NUT ANCHORING IT IN PLACE

LOCKING THE NUT WILL STABILIZE THE FIXING AND STRENGTHENS THE STRUCTURAL INTEGRITY OF THE UNISTRUT

CURVED EDGE ALLOWS FOR EASIER ROTATION

PHOENIX HORIZONTAL - HORIZONTAL FRAMEWORK

TBA PROTECTIVE TECHNOLOGIES LTD  
 Unit 3, Transpennine Trading Estate,  
 Gorrells Way Rochdale, OL11 2PX,  
 United Kingdom  
 T: +44 (0)1706 758 817  
 E: Technical@TBAFIREFLY.COM  
 W: WWW.TBAFIREFLY.COM

DESIGNER: JC

APPROVED: KG

DATE: 16/09/2024

SCALE: NTS

DRAWING NO:

PH - 451

REVISION: 1

IN SEQUENCE: 1/1

All rights reserved. No parts of this drawing may be used reproduced, altered, stored in a retrieval system or transmitted in any form or by any means without the prior written permission of tba protective technologies ltd. Whilst every effort has been made to comply with the current statutory regulations, it is the user's responsibility to ensure that the final detailing and installation meets the requirements of relevant regulatory authority (often building control). Please check www.tbafirefly.com to ensure that you are using the correct and current version. Copyright © 2023



DO NOT SCALE. IF IN DOUBT ASK!

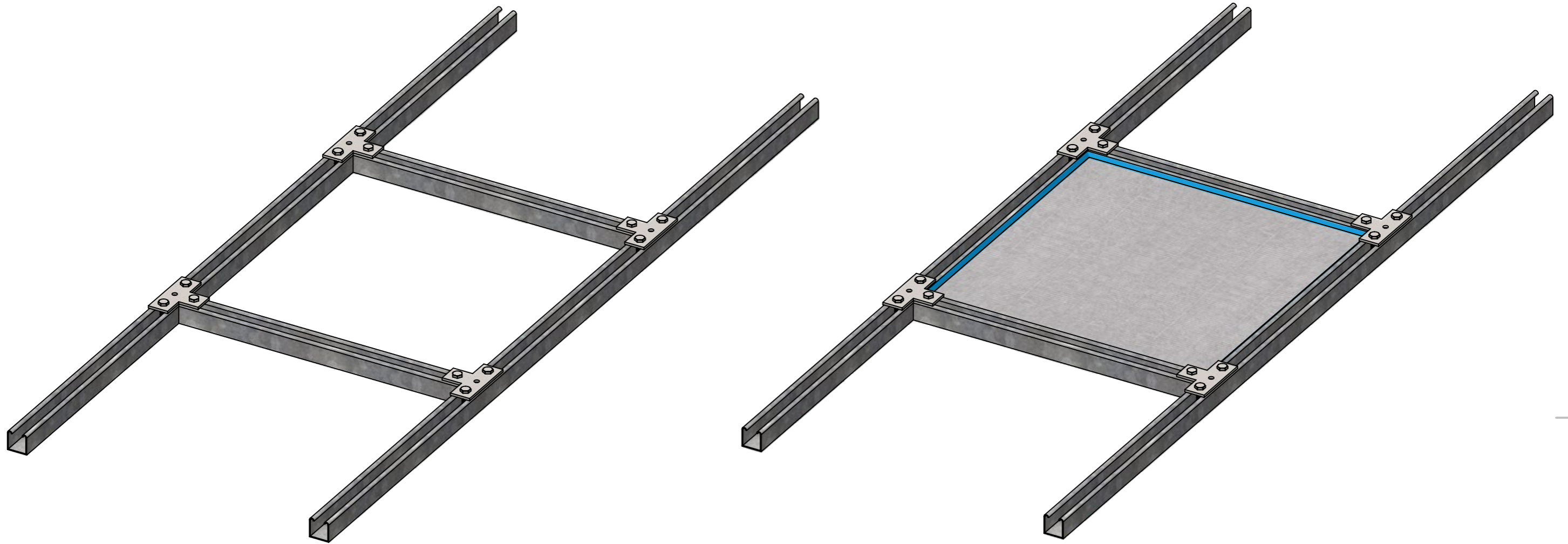

HORIZONTAL FRAMEWORK AS PER (PH-451)

THE ABLATIVE BATT EDGES ARE BUTTERED WITH FIREFLY® ABLATIVE COATING BEFORE BEING FRICTION FIT WITHIN THE FRAMEWORK

THE JOINTS BETWEEN THE BATT AND FRAMEWORK ARE THEN SEALED WITH A 6mm BEAD OF FIREFLY® INTUMESCENT ACRYLIC, FLATTENED OVER THE JOINT ON AT LEAST ONE SIDE OF THE ASSEMBLY

THE FRAMEWORK IS INSTALLED IN THE DESIRED LOCATION (PH-451)

THE BATTS OUTER EDGES ARE BUTTERED WITH FIREFLY® ABLATIVE COATING BEFORE BEING FRICTION FIT INTO THE FRAMEWORK

THIS DETAIL CAN BE FIT WITH PENETRATIONS FROM THE BATT FLOOR SYSTEM FOR MORE INFORMATION PLEASE SEE DETAILS: (B-301 TO B-399)

PENETRATIONS THROUGH THIS SYSTEM WILL ONLY BE RATED FOR (UP TO) THE RATING OF THE BARRIER USED



All rights reserved. No parts of this drawing may be used reproduced, altered, stored in a retrieval system or transmitted in any form or by any means without the prior written permission of tba protective technologies ltd. Whilst every effort has been made to comply with the current statutory regulations, it is the user's responsibility to ensure that the final detailing and installation meets the requirements of relevant regulatory authority (often building control). Please check www.tbafirefly.com to ensure that you are using the correct and current version. Copyright © 2023

PHOENIX HORIZONTAL - BATT INTO HORIZONTAL FRAMEWORK

TBA PROTECTIVE TECHNOLOGIES LTD Unit 3, Transpennine Trading Estate, Gorrells Way Rochdale, OL11 2PX, United Kingdom T: +44 (0)1706 758 817 E: Technical@TBAFIREFLY.COM W: WWW.TBAFIREFLY.COM	DESIGNER: JC	DRAWING NO:
	APPROVED: KG	PH - 453
	DATE: 16/09/2024	REVISION: 1
	SCALE: NTS	IN SEQUENCE: 1/1