

QB-PD45-P-07

Plastic Pipe penetrating a Profiled Deck



This standard detail is intended for general information only and all details should be checked against all relevant supporting test evidence, certification and installation guidelines. In line with the company's policy of continual development, details are subject to change and/ or withdrawal therefore you must ensure this is the latest published detail and instructions.

Additional Instructions

Trapezoidal steel profile deck floor, minimum 45mm thickness at the thinnest part of the slab and a minimum of 120mm depth at the thickest part of the slab. Minimum concrete density 2370kg/m³.

Core drilled aperture should be ≤72mm larger than the pipe penetration and the pipe penetration may be fitted concentric or eccentric within the aperture, provided the gap between the pipe and the concrete slab (often called annulus) is filled with rock fibre insulation, with a minimum density of 45kg/m³ installed the full depth of the concrete slab and around the full perimeter of the pipe. The maximum gap between the pipe and concrete slab in any direction should be ≤36mm.

A single layer of 50mm thick QuelStop Fire Batt should be pattress installed to the underside of the metal deck, bedded to the trough using QuelStop Intumescent Acrylic Sealant, and mechanically fixed to the substrate with a minimum size 6 x 100mm steel countersunk concrete screws and 25mm dia. steel retaining washers. Fixings installed in the centre of the 50mm overlap at maximum 230mm centres and in every corner of the QuelStop Fire Batt seal. The batt must have a single joint across the centre line of the batt/pipe (as tested) or no joints.

Overlap of the QuelStop Fire Batt to profile trough should be a minimum of 50mm. If the position of the core drilled hole is such that the overlap cannot be achieved on nearest trough, then the QuelStop Fire Batt must extend to the next full profile trough so that the minimum 50mm overlap can be achieved. All ends of the profile should be filled with a layer of QuelStop Fire Batt and sealed with QuelStop Acrylic Sealant across the entire thickness of the Batt as per our normal installation guidance.

Correct size QWR Collar for the pipe size secured to the underside of the Batt with 40mm long Quelfire steel pigtail screws.

All edges, cuts and joints of the QuelStop Fire Batt tightly butted and 'battered' sealed with QuelStop Acrylic Sealant across the entire thickness of the QuelStop Fire Batt. All exposed mineral wool edges, screw heads and washers should be 'battered' with a layer of QuelStop Acrylic Sealant or coated with QuelStop Ablative Coating.

Plastic Pipe Type	Page No.
U-PVC	1
HDPE	2
PP	3

Quelfire Products Required	
Product Code	Description
QWR Fire Collar	QWR Fire Collar for plastic pipes
QB50D	QuelStop Fire Batt
QSS310	QuelStop Intumescent Acrylic Sealant
QSC5KG	QuelStop Ablative Coating (5kg Tub)

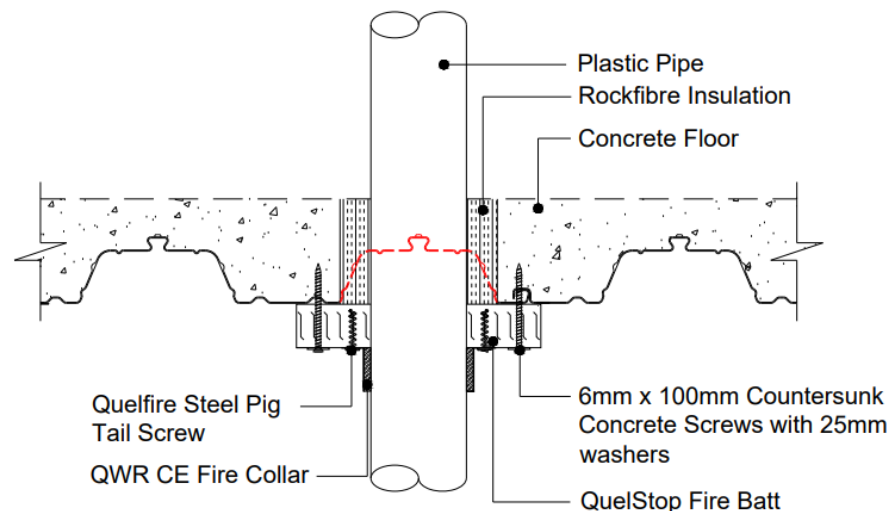

Service Type	Size of Services	Pipe Wall Thickness	QWR Fire Collar Required	Classification
U-PVC Pipe	Ø25mm	1.9 - 3.0mm	QWR25/CE	EI 60 U/C
	Ø32mm		QWR32/CE	
	Ø40mm		QWR40/CE	
	Ø50mm	2.9 - 3.8mm	QWR50/CE	
	Ø55mm		QWR55/CE	
	Ø63mm		QWR63/CE	
	Ø75mm		QWR75/CE	
	Ø82mm	3.2 - 6.6mm	QWR82/CE	
	Ø90mm		QWR90/CE	
	Ø110mm		QWR110/CE	
Ø125mm	6.5mm	QWR125/CE		
Ø160mm	6.2mm	QWR160/CE		

To be read in conjunction with:	WF Classification Report 401716 Issue 6, Pages 48 & 49
Test standard:	BS EN1366-3:2009 & EN13501-2:2016
Substrate minimum thickness:	45mm (thinnest part of the structure)
First service support:	≤400mm
Drawing Scale:	Not to Scale
Issue Number:	2
Date of Issue:	October 2021
Detail Reference:	QB-PD45-P-07

Important Information:

- The supporting construction must be installed in accordance with the manufacturer's guidelines and must be capable of achieving the required fire rating of the firestop.
- All Services should be adequately supported either side of the firestop to ensure that no load is transferred onto the firestop seal.

Scope and Liability:

- Any Information provided by or on behalf of Quelfire Limited is provided for general information only. It is not intended to amount to advice on which you should rely. You must obtain professional or specialist advice before taking, or refraining from, any recommendation or action.
- The summary is not exhaustive and does not consider all issues relevant to the enquiry. It is limited to the information and time available to us. We have not verified any information made available to us by you or any other source, nor have we carried out a physical inspection of any property. We make no representations, warranties or guarantees, whether expressed or implied, that any information is accurate, complete or up to date.
- We do not accept a duty of care to you or any other person in respect of the enquiry, nor do we accept any liability to you or any other person for any loss arising out of or in connection with the enquiry or any reply provided by us. Different limitations and exclusions of liability arising as a result of the supply of any products or services by us to you, and these will be set out in our terms and conditions of supply, a copy of which is available on request.
- Full terms and conditions of sale are available at <https://www.quelfire.co.uk/terms-conditions-of-sale/>

QB-PD45-P-07

Plastic Pipe penetrating a Profiled Deck



This standard detail is intended for general information only and all details should be checked against all relevant supporting test evidence, certification and installation guidelines. In line with the company's policy of continual development, details are subject to change and/ or withdrawal therefore you must ensure this is the latest published detail and instructions.

Additional Instructions

Trapezoidal steel profile deck floor, minimum 45mm thickness at the thinnest part of the slab and a minimum of 120mm depth at the thickest part of the slab. Minimum concrete density 2370kg/m³.

Core drilled aperture should be ≤72mm larger than the pipe penetration and the pipe penetration may be fitted concentric or eccentric within the aperture, provided the gap between the pipe and the concrete slab (often called annulus) is filled with rock fibre insulation, with a minimum density of 45kg/m³ installed the full depth of the concrete slab and around the full perimeter of the pipe. The maximum gap between the pipe and concrete slab in any direction should be ≤36mm.

A single layer of 50mm thick QuelStop Fire Batt should be pattress installed to the underside of the metal deck, bedded to the trough using QuelStop Intumescent Acrylic Sealant, and mechanically fixed to the substrate with a minimum size 6 x 100mm steel countersunk concrete screws and 25mm dia. steel retaining washers. Fixings installed in the centre of the 50mm overlap at maximum 230mm centres and in every corner of the QuelStop Fire Batt seal. The batt must have a single joint across the centre line of the batt/pipe (as tested) or no joints.

Overlap of the QuelStop Fire Batt to profile trough should be a minimum of 50mm. If the position of the core drilled hole is such that the overlap cannot be achieved on nearest trough, then the QuelStop Fire Batt must extend to the next full profile trough so that the minimum 50mm overlap can be achieved. All ends of the profile should be filled with a layer of QuelStop Fire Batt and sealed with QuelStop Acrylic Sealant across the entire thickness of the Batt as per our normal installation guidance.

Correct size QWR Collar for the pipe size secured to the underside of the Batt with 40mm long Quelfire steel pigtail screws.

All edges, cuts and joints of the QuelStop Fire Batt tightly butted and 'battered' sealed with QuelStop Acrylic Sealant across the entire thickness of the QuelStop Fire Batt. All exposed mineral wool edges, screw heads and washers should be 'battered' with a layer of QuelStop Acrylic Sealant or coated with QuelStop Ablative Coating.

Plastic Pipe Type	Page No.
U-PVC	1
HDPE	2
PP	3

Quelfire Products Required	
Product Code	Description
QWR Fire Collar	QWR Fire Collar for plastic pipes
QB50D	QuelStop Fire Batt
QSS310	QuelStop Intumescent Acrylic Sealant
QSC5KG	QuelStop Ablative Coating (5kg Tub)

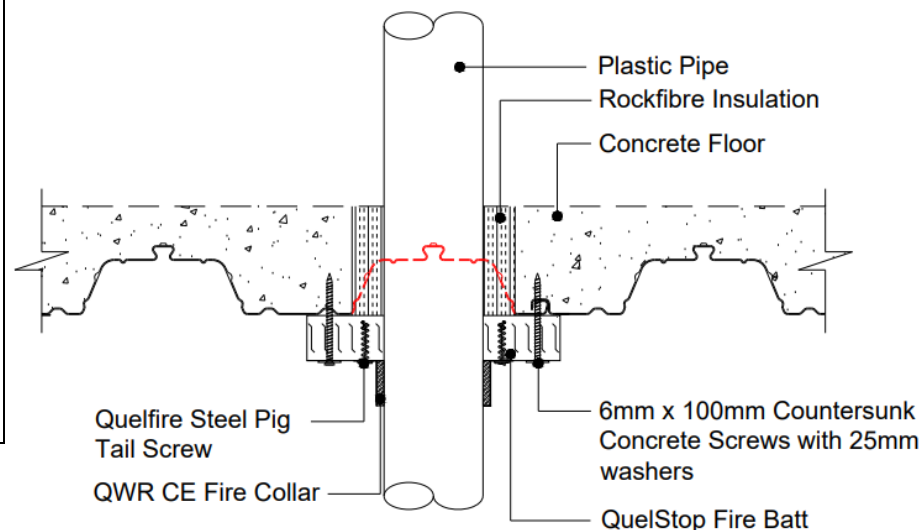

Service Type	Size of Services	Pipe Wall Thickness	QWR Fire Collar Required	Classification
HDPE Pipe	Ø25mm	2.4 - 3.7mm	QWR25/CE	EI 60 U/C
	Ø32mm		QWR32/CE	
	Ø40mm		QWR40/CE	
	Ø50mm	2.6 - 4.3mm	QWR50/CE	
	Ø55mm		QWR55/CE	
	Ø63mm		QWR63/CE	
	Ø75mm		QWR75/CE	
	Ø82mm		QWR82/CE	
	Ø90mm	3.4 - 6.6mm	QWR90/CE	
	Ø110mm		QWR110/CE	
	Ø125mm		QWR125/CE	
Ø160mm	4.0 - 9.5mm	QWR160/CE		

To be read in conjunction with:	WF Classification Report 401716 Issue 6, Pages 48 & 49
Test standard:	BS EN1366-3:2009 & EN13501-2:2016
Substrate minimum thickness:	45mm (thinnest part of the structure)
First service support:	≤400mm
Drawing Scale:	Not to Scale
Issue Number:	2
Date of Issue:	October 2021
Detail Reference:	QB-PD45-P-07

Important Information:

- The supporting construction must be installed in accordance with the manufacturer's guidelines and must be capable of achieving the required fire rating of the firestop.
- All Services should be adequately supported either side of the firestop to ensure that no load is transferred onto the firestop seal.

Scope and Liability:

- Any Information provided by or on behalf of Quelfire Limited is provided for general information only. It is not intended to amount to advice on which you should rely. You must obtain professional or specialist advice before taking, or refraining from, any recommendation or action.
- The summary is not exhaustive and does not consider all issues relevant to the enquiry. It is limited to the information and time available to us. We have not verified any information made available to us by you or any other source, nor have we carried out a physical inspection of any property. We make no representations, warranties or guarantees, whether expressed or implied, that any information is accurate, complete or up to date.
- We do not accept a duty of care to you or any other person in respect of the enquiry, nor do we accept any liability to you or any other person for any loss arising out of or in connection with the enquiry or any reply provided by us. Different limitations and exclusions of liability arising as a result of the supply of any products or services by us to you, and these will be set out in our terms and conditions of supply, a copy of which is available on request.
- Full terms and conditions of sale are available at <https://www.quelfire.co.uk/terms-conditions-of-sale/>

QB-PD45-P-07

Plastic Pipe penetrating a Profiled Deck



This standard detail is intended for general information only and all details should be checked against all relevant supporting test evidence, certification and installation guidelines. In line with the company's policy of continual development, details are subject to change and/ or withdrawal therefore you must ensure this is the latest published detail and instructions.

Additional Instructions

Trapezoidal steel profile deck floor, minimum 45mm thickness at the thinnest part of the slab and a minimum of 120mm depth at the thickest part of the slab. Minimum concrete density 2370kg/m³.

Core drilled aperture should be ≤72mm larger than the pipe penetration and the pipe penetration may be fitted concentric or eccentric within the aperture, provided the gap between the pipe and the concrete slab (often called annulus) is filled with rock fibre insulation, with a minimum density of 45kg/m³ installed the full depth of the concrete slab and around the full perimeter of the pipe. The maximum gap between the pipe and concrete slab in any direction should be ≤36mm.

A single layer of 50mm thick QuelStop Fire Batt should be pattress installed to the underside of the metal deck, bedded to the trough using QuelStop Intumescent Acrylic Sealant, and mechanically fixed to the substrate with a minimum size 6 x 100mm steel countersunk concrete screws and 25mm dia. steel retaining washers. Fixings installed in the centre of the 50mm overlap at maximum 230mm centres and in every corner of the QuelStop Fire Batt seal. The batt must have a single joint across the centre line of the batt/pipe (as tested) or no joints.

Overlap of the QuelStop Fire Batt to profile trough should be a minimum of 50mm. If the position of the core drilled hole is such that the overlap cannot be achieved on nearest trough, then the QuelStop Fire Batt must extend to the next full profile trough so that the minimum 50mm overlap can be achieved. All ends of the profile should be filled with a layer of QuelStop Fire Batt and sealed with QuelStop Acrylic Sealant across the entire thickness of the Batt as per our normal installation guidance.

Correct size QWR Collar for the pipe size secured to the underside of the Batt with 40mm long Quelfire steel pigtail screws.

All edges, cuts and joints of the QuelStop Fire Batt tightly butted and 'battered' sealed with QuelStop Acrylic Sealant across the entire thickness of the QuelStop Fire Batt. All exposed mineral wool edges, screw heads and washers should be 'battered' with a layer of QuelStop Acrylic Sealant or coated with QuelStop Ablative Coating.

Plastic Pipe Type	Page No.
U-PVC	1
HDPE	2
PP	3

Quelfire Products Required	
Product Code	Description
QWR Fire Collar	QWR Fire Collar for plastic pipes
QB50D	QuelStop Fire Batt
QSS310	QuelStop Intumescent Acrylic Sealant
QSC5KG	QuelStop Ablative Coating (5kg Tub)

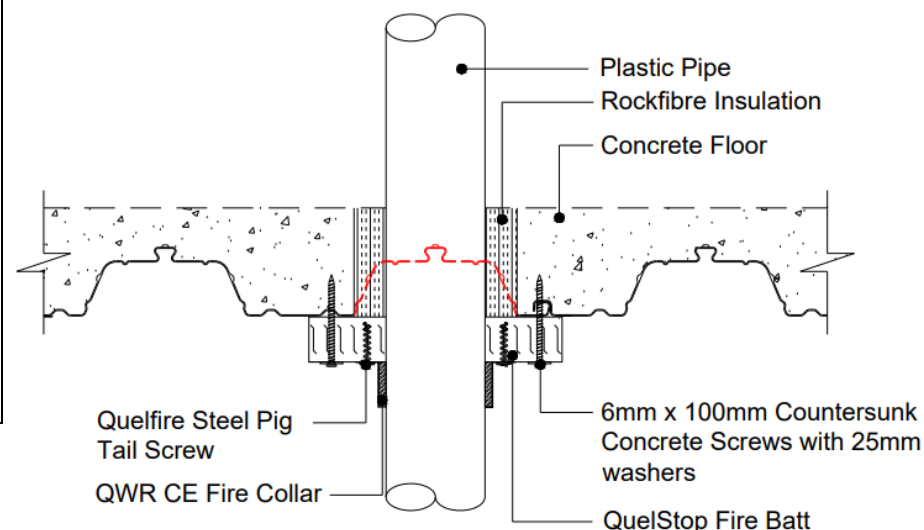

Service Type	Size of Services	Pipe Wall Thickness	QWR Fire Collar Required	Classification
PP Pipe	Ø25mm	1.8 - 3.7mm	QWR25/CE	EI 60 U/C
	Ø32mm		QWR32/CE	
	Ø40mm		QWR40/CE	
	Ø50mm	2.0 - 5.1mm	QWR50/CE	
	Ø55mm		QWR55/CE	
	Ø63mm		QWR63/CE	
	Ø75mm	2.7 - 10.0mm	QWR75/CE	
	Ø82mm		QWR82/CE	
	Ø90mm		QWR90/CE	
	Ø110mm		QWR110/CE	
	Ø125mm	3.1 - 8.2mm	QWR125/CE	
	Ø160mm	4.0mm	QWR160/CE	

To be read in conjunction with:	WF Classification Report 401716 Issue 6, Pages 48 & 49
Test standard:	BS EN1366-3:2009 & EN13501-2:2016
Substrate minimum thickness:	45mm (thinnest part of the structure)
First service support:	≤400mm
Drawing Scale:	Not to Scale
Issue Number:	2
Date of Issue:	October 2021
Detail Reference:	QB-PD45-P-07

Important Information:

- The supporting construction must be installed in accordance with the manufacturer's guidelines and must be capable of achieving the required fire rating of the firestop.
- All Services should be adequately supported either side of the firestop to ensure that no load is transferred onto the firestop seal.

Scope and Liability:

- Any Information provided by or on behalf of Quelfire Limited is provided for general information only. It is not intended to amount to advice on which you should rely. You must obtain professional or specialist advice before taking, or refraining from, any recommendation or action.
- The summary is not exhaustive and does not consider all issues relevant to the enquiry. It is limited to the information and time available to us. We have not verified any information made available to us by you or any other source, nor have we carried out a physical inspection of any property. We make no representations, warranties or guarantees, whether expressed or implied, that any information is accurate, complete or up to date.
- We do not accept a duty of care to you or any other person in respect of the enquiry, nor do we accept any liability to you or any other person for any loss arising out of or in connection with the enquiry or any reply provided by us. Different limitations and exclusions of liability arising as a result of the supply of any products or services by us to you, and these will be set out in our terms and conditions of supply, a copy of which is available on request.
- Full terms and conditions of sale are available at <https://www.quelfire.co.uk/terms-conditions-of-sale/>