



United Kingdom
Testing and
Certification

Test Report

The fire resistance performance of fully insulated, timber, single acting double door assembly when tested in accordance with BS 476-22: 1987 § 6.

Project ID 20230602-000709

Revision A

Issue Date 27 September 2023

Date of Test 31 August 2023

Prepared For
Exitex UK Sales Ltd
St Johns Chamber
Love Street
Chester
CH1 1QN



21542

Cairnmuir House, Cairnmuir Road,
East Kilbride, Glasgow G74 4GY
+44 (0)1355 433 122
info@uktestcert.com
uktestcert.com

Trusted to ensure.

Change History

Issue Date	Revision	Created by	Authorised by	Description of Change
27/09/2023	A	NS	DF	Initial Issue

Signatories

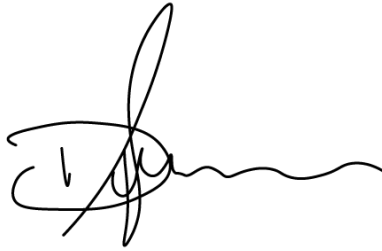
	
Prepared by Nathan Small * Technical Officer	Authorised by Daniel Fitzsimmons* Head of Testing

*For and on behalf of United Kingdom Testing and Certification.

Table of Contents

Change History	1
Signatories	1
Table of Contents	2
1 Executive Summary	4
1.1 Specimen Summary	4
1.2 Specimen Verification	4
1.3 Specimen Installation and Fixity	4
1.4 Specimen Conditioning	4
1.5 Instruction to Test.....	4
1.6 Sampling	5
1.7 Expression of Results.....	6
2 Pre-test Examination.....	7
2.1 Closing Force Measurement	7
2.2 Gap Measurements	8
3 Test Specimen Drawings.....	9
4 Technical Schedule	14
4.1 Specimen.....	14
4.2 Supporting Construction.....	20
5 Specimen Photographs	23
6 Test Procedure.....	24
6.1 Heating Conditions	24
6.2 Pressure Conditions	24
6.3 Unexposed Surface Temperature	24
6.4 Deflection.....	25

7	Observations	26
8	Test Images	27
9	On-going Implications	32
9.1	Limitations	32
9.2	Accuracy of Results	32
9.3	Fire Test Study Group (FTSG)	32
10	Figures	33
11	Tables	36
Appendix A	Sample Report.....	39

1 Executive Summary

1.1 Specimen Summary

The Specimen had overall nominal dimensions of 2074 mm wide by 2440 mm high, incorporating two door leaves each with overall dimensions of 1000 mm wide by 2400 mm high by 54 mm thick. The door leaves were formed from a 54 mm thick particleboard core with 8 mm thick hardwood lippings to all four edges. The leaves were hung in a hardwood frame each on four steel hinges.

1.2 Specimen Verification

United Kingdom Testing and Certification carried out a comprehensive survey to verify the information provided by the Test Sponsor. This included verifying the materials, dimensions, and manufacturing methodologies of the test specimens wherever possible. Refer to page 14 for full details of this survey.

1.3 Specimen Installation and Fixity

The Specimen was installed into the test construction by United Kingdom Testing and Certification. The specimen was installed such that the door leaf opened towards the heating conditions at the request of the Test Sponsor. The specimen was unlatched but bolted prior to the commencement of the test at the request of the test sponsor.

1.4 Specimen Conditioning

The specimen's storage, construction, and test preparation took place in the test laboratory over a total, combined time of three days. Throughout this period, both the temperature and the humidity of the laboratory were measured and recorded as being within a range of from 14.1 °C to 16.0 °C and 64.8 % to 75.8 % respectively.

The date of receipt of specimen(s) at the laboratory was 28 August 2023

1.5 Instruction to Test

The test was conducted on 31 August 2023 at the request of the Test Sponsor. The test was witnessed by Mr Mark Thorne, a representative of the Test Sponsor.

1.6 Sampling

United Kingdom Testing and Certification was not involved in the sampling or selection of the tested specimen or any of the components. A representative of Warringtonfire Testing and Certification Limited, trading as BM TRADA sample selected the following components of the tested specimen:

Component	Sampling date	Sampling report reference
Falcon Strebord (54mm) unglazed double door, hung in a sapele frame	25/08/2023	SCT23213

Refer to page 39 for the copies of the sampling reports.

1.7 Expression of Results

The performance criterion specified in BS 476-20: 1987 § 10 was satisfied for the following intervals:

Integrity¹	61 minutes	Sustained flaming failure
Insulation²	61 minutes	Due to Integrity Failure

*The test was discontinued after a period of 62 minutes.

¹ The time(s) in completed minutes for which the test specimen(s) continues to maintain its separating function without: a) causing ignition to the cotton pad applied in accordance with BS 476-20:1987 § 10.3.2; b) permitting the penetration of a gap gauge as specified in BS 476-20: 1987 § 10.3.2; c) resulting in sustained flaming

² The time(s) in completed minutes for which the test specimen(s) continues to maintain its separating function without developing temperatures on its unexposed surface which: a) increase the average temperature above the initial average temperature by more than 140 °C; b) increase at any location (including the roving thermocouple) above the initial average temperature by more than 180°C.

2 Pre-test Examination

2.1 Closing Force Measurement

The door closing forces were measured and recorded three times. The results are presented below:

Measurement	Maximum Recorded Force (N)	Distance from Pivot to Measurement Location (m)	Moment (Nm)
Closing Force Specimen A	79.1	0.750	59.325
Opening Force Specimen A	37.2	0.750	27.9
Closing Force Specimen B	73.0	0.750	54.75
Opening Force Specimen B	34.6	0.750	25.95

2.2 Gap Measurements

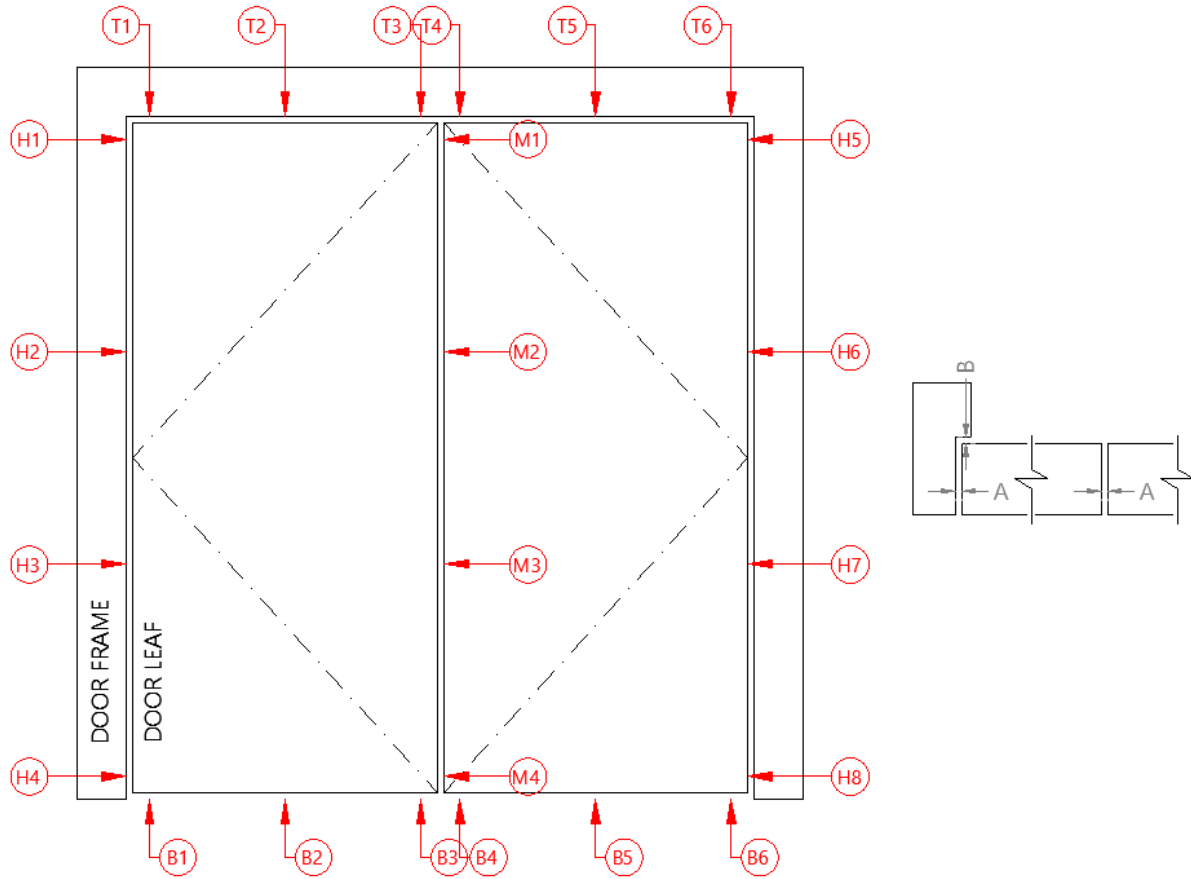

	A	B		A	B		A	B	
H1	3.8	0.5	X	M1	2.2	X	H5	3.8	0.1
H2	3.9	0.3		M2	2.5		H6	3.0	0.1
H3	3.1	0.7		M3	3.1		H7	2.4	0.3
H4	3.6	0.1		M4	3.4		H8	4.1	0.1
Mean	3.6	X	Mean	2.8	X	Mean	3.3	X	
Max	3.9		Max	3.4		Max	4.1		
Min	3.1		Min	2.2		Min	2.4		
	A	B		A	B		A	B	
T1	2.3	0.3	T4	3.2	0.2	B1	6.7	B4	7.1
T2	3.0	0.2	T5	3.3	0.1	B2	7.2	B5	7.5
T3	3.0	0.1	T6	3.4	0.1	B3	7.4	B6	7.1
Mean	2.8	X	Mean	3.3	X	Mean	7.1	Mean	7.2
Max	3.0		Max	3.4		Max	7.4	Max	7.5
Min	2.3		Min	3.2		Min	6.7	Min	7.1

3 Test Specimen Drawings

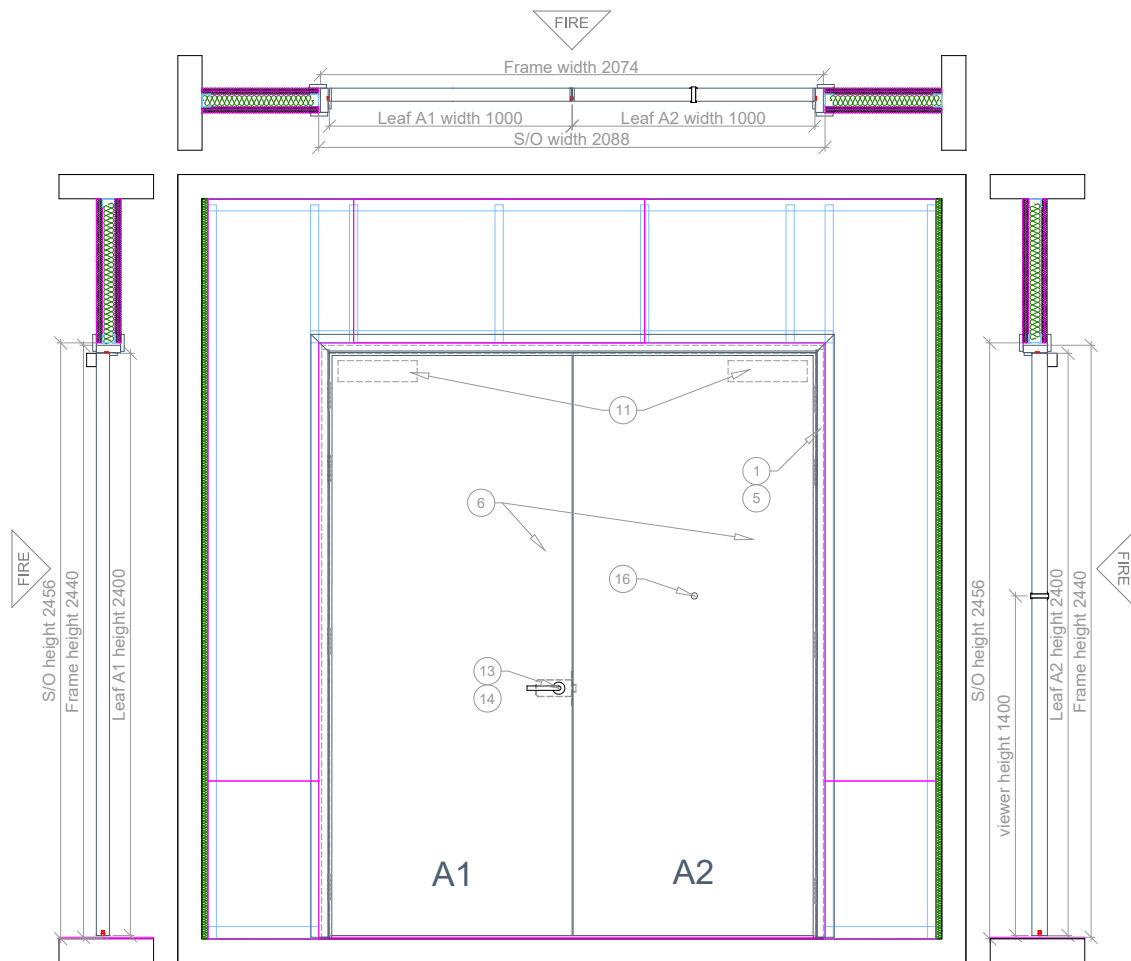

Figure 1 - General arrangement of test construction viewed from the unexposed surface

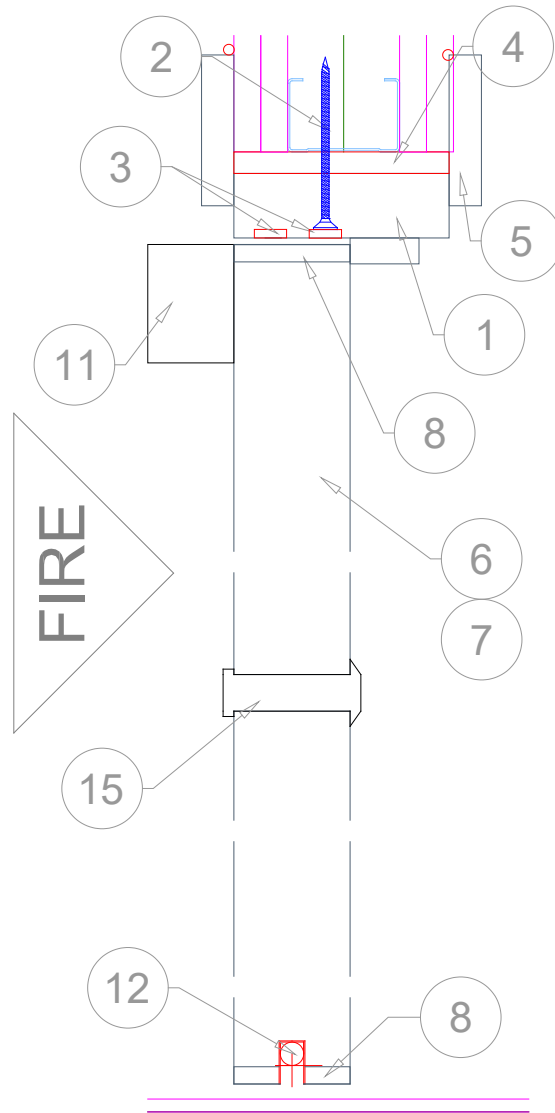

Figure 2 - Typical vertical section through The Specimen

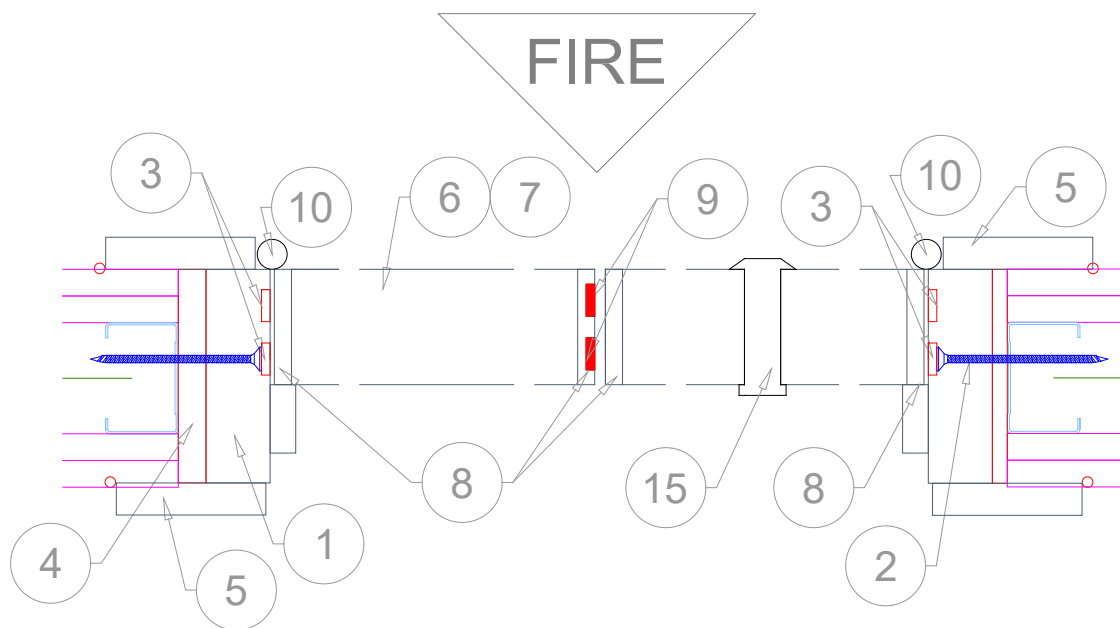

Figure 3 - Typical horizontal section through The Specimen

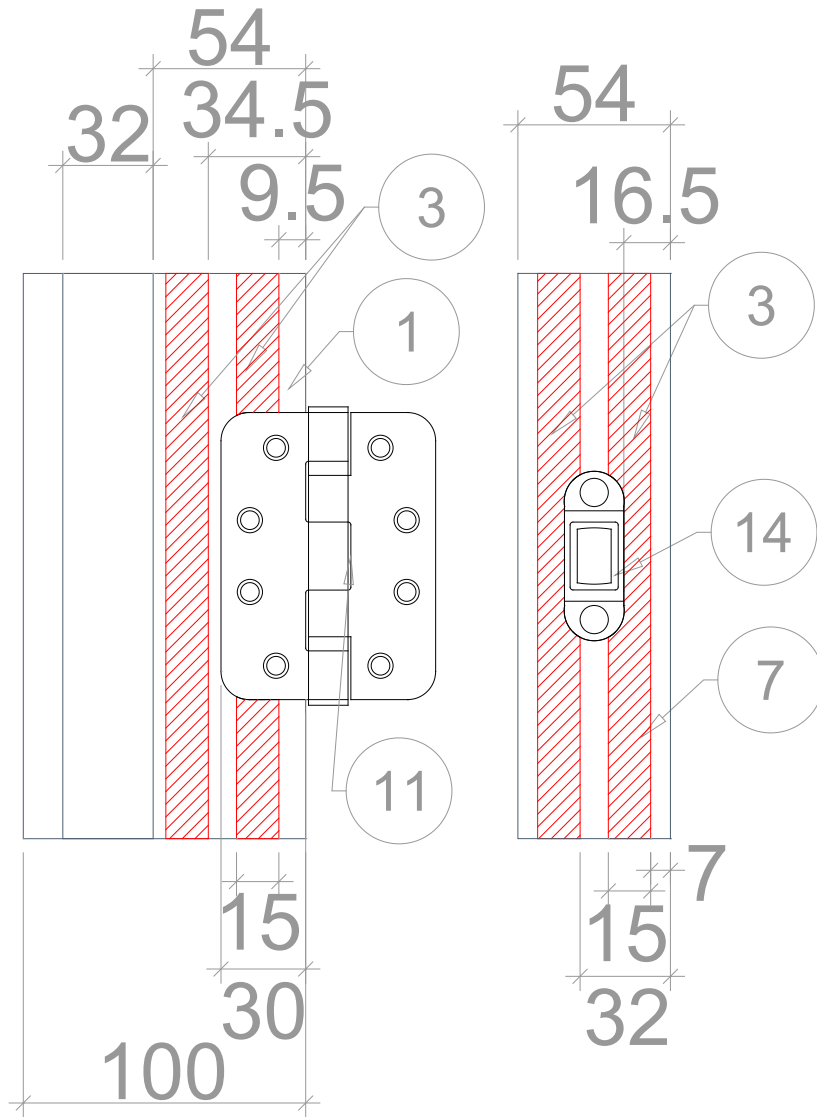

Figure 4 - Hardware intumescent interruptions

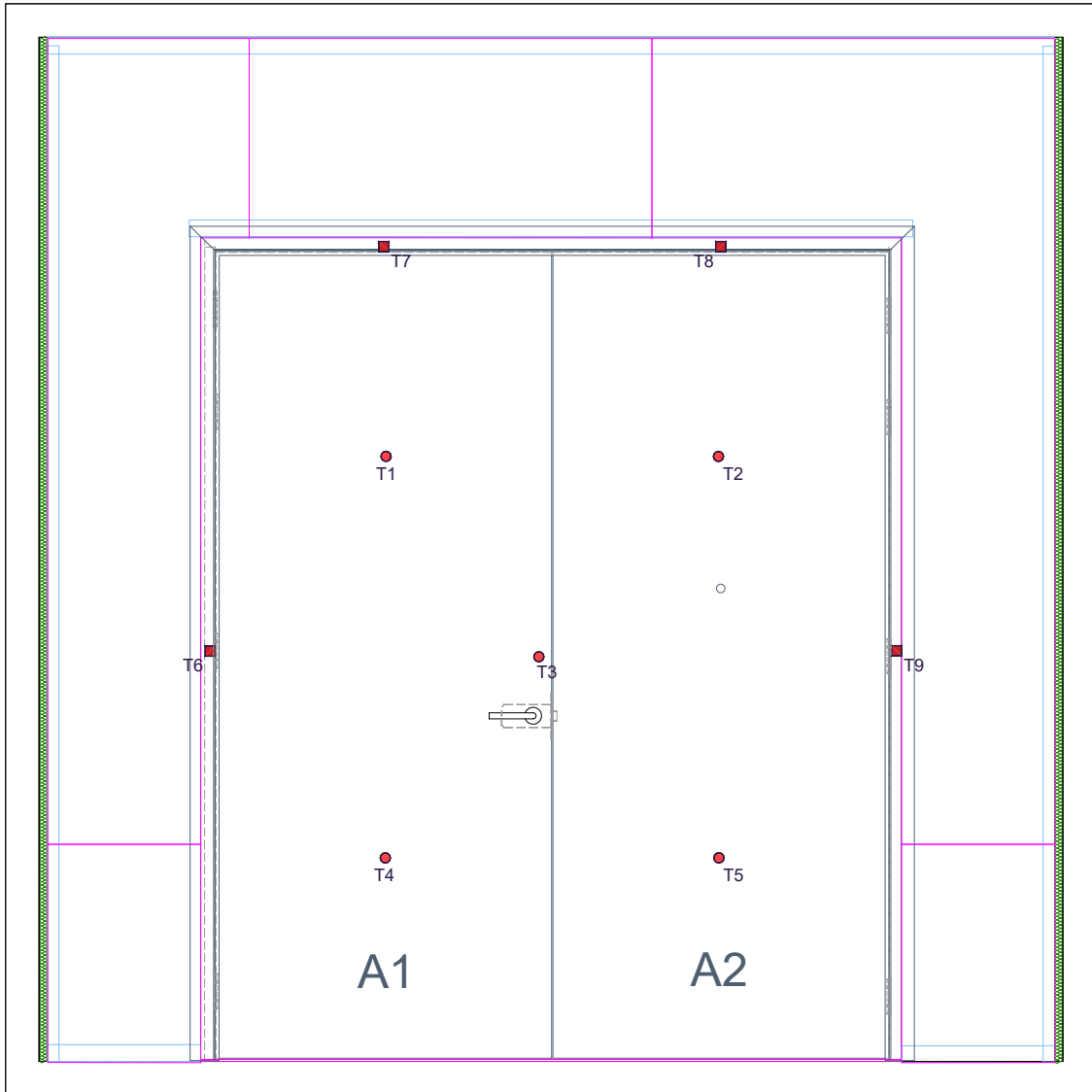

Figure 5 - Layout of instrumentation viewed from the unexposed surface of the test construction

4 Technical Schedule

All dimensions are in millimetres (mm) unless otherwise stated.

* Information provided by the Test Sponsor. Not verified by United Kingdom Testing and Certification.

** Nominal value.

*** Information is commercial in confidence. Full details retained on file by United Kingdom Testing and Certification.

4.1 Specimen

1. Frame	
Manufacturer	DorSuite Ltd
Reference	Sapele Frames
Material	Sapele Head and Sapele Jambs
Density	640 kg/m ³
Moisture content	9.6 – 11.2 %
Orientation to heating conditions	
a. Overall size	2074 mm wide x 2440 mm high
i. Frame (Head)	100 mm wide x 32 mm thick
ii. Frame (Jambs)	100 mm wide x 32 mm thick
iii. Loose Stop	32 mm wide x 12 mm deep
Jamb to Head jointing method, fixing detail and location	Housed butt joint with PVA & 2 No. Ø 0.5 mm x 60 mm long wood screws. *
Stop to Frame jointing method, fixing detail and location	Pinned with 1.8 mm gauge x 38 mm long steel pins @ 300 mm centres.
2. Frame Fixing Method to Supporting Construction	
Manufacturer	Spax
Reference	4Cut
Type & material	Passivated Steel
Overall size	Ø 5 mm x 80 mm long
Spacing	150 mm from top corner of jamb, 150 mm from bottom corner of jamb and at no more than 600 mm centres
Does the fixing penetrate intumescent seal within frame reveal	No

Packing Material	Sapele
Packing Material Dimension	35 mm wide x various thicknesses x depth of wall
Packing Material Location	At each fixing location up frame
3. Intumescent to frame reveal (1)	
Quantity	2
Manufacturer	EXITEX *
Reference	1.31.0330.2100.35 Exitex LT intumescent strip *
Material	Graphite
Overall section size	15 mm wide x 4 mm thick
Application method	Adhesive strip to back
Location (relative to the opening face of the door leaf)	9.5 mm & 34.5 mm from opening face
a. Adhesive(s)	N/A
4. Frame to supporting construction fire stopping detail	
Manufacturer	EXITEX
Reference	Blue 60
Material	Fire Rated Foam
Overall dimension	Depth of wall x 15 - 20 mm wide
Application method	Foam applicator Gun, Left to Cure then cut back before architraves applied. No mastic or sealants applied ontop.
Batch ID	0976 (12.05.22)
5. Architrave	
Manufacturer	DorSuite Ltd
Reference	MDF Architraves
Material	MDF
Overall section size	70 mm wide x 15 mm thick
Location	Each side of frame
Application method, fixings and fixing frequency required	Pinned with 1.8 mm gauge x 50 mm long steel pins @ 300 mm centres.
Additional notes	Certitek intumescent mastic used to seal along perimeter of architraves to supporting construction

6. Door Leaf	
Manufacturer (blank)	Falcon Panel Products *
Reference	Strebord 54 *
Quantity of leaves on doorset	2
Overall leaf size supplied for testing	1000 mm wide x 2400 mm high x 54 mm thick
Door Undercut (Top of cill / bottom of frame)	7 mm
7. Core element 1	
Manufacturer	Falcon Panel Products *
Reference	Strebord 54 *
Material	Particle board
Density	520 kg/m ³
Overall thickness and reduced thickness if door leaf incorporates fielded areas	54 mm thick
Application method	N/A*
8. Lippings / Edge banding	
Manufacturer	DorSuite Ltd
Reference	LIP-0000
Material	Sapele
Density	640 kg/m ³
b. Moisture content	
i. A1	9.2 – 10.3 %
ii. A2	11.8 – 12.5 %
Overall size	8 mm deep x 54 mm wide
Fixing method	Edge bander *
Location	All edges of the door leaf *
a. Adhesives	
i. Manufacturer	Henkel *
ii. Type	PUR *
iii. Reference	Technomelt PUR 270/7G *

iv. Curing method	Moisture Cured *
v. Application method	Roller applied *
b. Presence of Mechanical Fixings	No *
9. Intumescent on meeting stiles	
Quantity	2
Manufacturer	EXITEX *
Reference	1.31.0330.2100.35 Exitex LT intumescent strip *
Material	Graphite
Overall section size	15 mm wide x 4 mm thick
Application method	Adhesive strip to back
Location (relative to the opening face of the door leaf)	7 mm & 32 mm from opening face
a. Presence of Adhesives	N/A
10. Hinges	
Supplier	DorSuite Ltd
Reference	PP20070102
Quantity	4 per leaf
Primary material	Stainless Steel
Type	Grade 13 Butt Hinges
a. Size	
i. Knuckle	Ø 14.5 mm x 107 mm high
ii. Blades	102 mm high x 31 mm wide x 2 mm thick
b. Fixings	
i. Type	Countersunk Screws
ii. Material	Stainless Steel
iii. Size	Ø 4.5 mm x 32 mm long
iv. Number off per blade	4
Position of each hinge relative to the head of the leaf	120 mm, 422 mm, 1134 mm, 2148 mm

Details of intumescent protection	2 mm Graphite
Interruptions to Intumescent within the frame reveal	Fully interrupts 1 intumescent
11. Door Closer	
Supplier	DorSuite Ltd
Reference	BR5004040307 * TS9205BC
a. Material	
i. Body	Mild Steel *
ii. Closer arm	Mild Steel *
iii. Cover	Stainless Steel *
Configuration	Fig 1
b. Overall size	
i. Body	55 mm high x 236 mm wide x 39 mm deep
ii. Cover	70 mm high x 270 mm wide x 40 mm deep
Fixing method	4 No. Ø 4.8 mm x 50 mm on body 2 No. Ø 4.8 mm x 52 mm on bracket into frame
12. Drop Down Seal	
Manufacturer	EXITEX *
Reference	Concealex A8100 1.50.0001.1026.31 *
a. Material	
i. Body	Aluminium *
ii. Seal	N/A *
b. Overall size	
i. Body	20 mm high x 12 mm wide x 1.5 mm thick
Fixing method, type and locations	2 No. screws to bottom of door with screws supplied Through pre-drilled holes *
Location within leaf	Central in bottom of door
Maximum operating drop	14 mm *

13. Tubular Latch	
Manufacturer	DorSuite Ltd *
Reference	AA36010245 Tubular latch *
a. Material	
i. Lockcase	Steel and Alloys *
ii. Forend plate	Steel and Alloys *
iii. Latch bolt	Steel and Alloys *
iv. keeper	Steel and Alloys *
b. Overall sizes	
i. Central Lockcase	57 mm high x 20 mm wide x 3 mm thick *
ii. Forend plate	12 mm high x 18 mm wide
iii. Latch bolt	76 mm high x 23 mm wide
iv. Keeper	61 mm high x 40 mm wide 1 mm thick
Fixing method	2 No. Ø 4 mm x 25 mm screws to forend plate 2 No. Ø 4 mm x 25 mm screws to keep
Operation of latch bolt	Disengaged
Intumescent	EXI-Fire intumescent 1mm Graphite to keep and forend plate
Location of centre of the spindle relative to the bottom of the leaf	Centre of the spindle measures 1020 mm from the bottom of the leaf
14. Lever handles	
Manufacturer	DorSuite Ltd *
Reference	PP11030407 19mm DIA RTD Lever on rose *
Material	Stainless Steel *
Overall size	Ø 18.5 mm x 140 mm long x 68 mm projection with Ø 51 mm rose
Fixing method, fixing material, sizes, quantity and location	4 No. Ø 3.9 mm x 20 mm long screws to each face of door 2 No. Ø 3.9 mm x 55 mm long through bolts
Details of intumescent protection	DorSuite Ltd *
15. Door viewer	

Supplier	DorSuite Ltd
Reference	PP60192010
Material	Steel SCP
a. Overall size	
i. Body	Ø 14 mm
ii. Footprint	Ø 26 mm to unexposed face, Ø 24.5 mm to exposed face
iii. Cut out	Ø 17 mm
Fixing method	Screwed threaded connection tightened until secured through Ø 11.5 mm through hole
Location	1400 mm from bottom of the leaf and 463 mm from door edge
Details of intumescent protection	1mm EXI-Fire intumescent *
16. Door Pin ID Tag	
Manufacturer	Door Data Systems
Reference	Data ID Tag
Material	Computer chip with dual plastic coating
Overall size	Ø 6 mm x 37.5 mm long
Location	A1 Hinge edge – 1320 mm from bottom of door and centred
Fixing method	Friction fitted into door edge.

4.2 Supporting Construction

17. Studs	
Supplier	United Kingdom Testing and Certification
c. Type & Material	Rolled steel C-Stud
iv. Dimensions	50 mm deep x 34 mm wide x 3000 mm long x 0.5 mm thick
v. Stud centres	400-625 mm
vi. Fixing(s)	Friction fitted to the head/ floor track
Timber Inserts to Studs	No

18. Head/ Floor Track	
Supplier	United Kingdom Testing and Certification
Type & Material	Rolled steel U-Track
Dimensions	52 mm deep x 25 mm wide x 3000 mm long x 0.5 mm thick
Centres	600 mm Centres 20 mm Space between testing frame and wall frame for insulation.
Fixing(s)	Ø 7.5 x 50 mm long self-tapping screws staggered at max 600 mm centres
19. Lining(s)	
Supplier	United Kingdom Testing and Certification
Type & Material	Paper faced, gypsum plasterboard type F
Density	760 Kg/m ³
Layer Quantity	2
Dimensions	12.5 mm thick x 1200 mm wide x 2400 mm high
Fixings	Plasterboard Screw Fixings Ø 5 mm x 25 mm
Joints Filled & Taped With	No nonsense
20. Wall Insulation	
Supplier	United Kingdom Testing and Certification
Type & Material	Mineral Wool
Density	33 Kg/m ³
Installation Method	Compression Fitted
Thickness	50 mm
Locations	Centrally Located in the wall
21. Free Edge Gasket	
Manufacturer	Morgan Advanced Materials
Reference	Superwool
Density	128 Kg/m ³
Dimensions	20 mm thick x 3025 mm long x 100 mm wide
Fixing(s)	Compression fitted between the supporting construction & restraint frame

22. Board for Simulated Floor Level	
Manufacturer	British Gypsum
Reference	Glasroc F MultiBoard 6mm
Density	833 Kg/m ³
Dimensions	6 mm thick x Opening width + 400 mm long x Wall Depth + 500 mm wide
Fixing(s)	Compression fitted between restraint frame and specimen.

5 Specimen Photographs



Figure 6 - Item 1, 5, 6, 7, 10, 11, 13, 14, 16



Figure 7 - Item 4, 8, 10

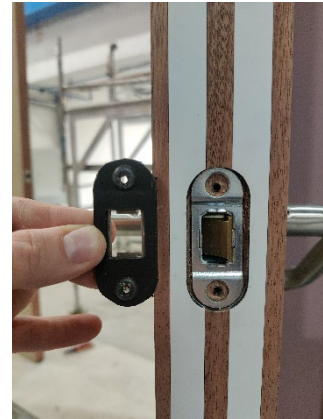

Figure 8 - Item 8, 9, 13, 14



Figure 9 - Item 2, 3, 8, 10



Figure 9 - Item 3, 8, 12



Figure 10 - Item 14



Figure 11 - Item 13



Figure 12 - Item 15



Figure 13 - Item 16

6 Test Procedure

6.1 Heating Conditions

The specimen was subject to heating conditions in accordance with BS 476-20:1987 § 3.1. This was monitored and controlled for the duration of the test using type K thermocouples which were distributed across a vertical plane 100 ± 10 mm from the exposed surface of the test construction. The resulting Time-Temperature distribution is presented in Figure 24.

6.2 Pressure Conditions

The specimen was subject to a pressure regime in accordance with BS 476-20: 1987 § 3.2. The calculated pressure differential relative to the laboratory atmospheric pressure at a height of 365, 1612 and 2850 mm from the furnace floor level was -5.4, 5.2 and 15.7 Pa respectively which equates to 0 Pa at a height of 1000 mm from the furnace floor level. The furnace was maintained at these pressures within ± 2 Pa five minutes after the commencement of the test and for the remainder of the test duration. The pressure did not deviate from the specified conditions throughout the duration of the test. The Time-Pressure distribution is presented in Figure 25.

6.3 Unexposed Surface Temperature

A roving thermocouple was available for the evaluation of the maximum temperature rise criteria in accordance with BS 476-20: 1987 § 10.4. Any measurements using the roving thermocouple are presented on page 26.

Disc thermocouples were affixed to the unexposed surface of the specimen in accordance with BS 476-22:1987 to measure and monitor the maximum and the mean temperature rise of the unexposed face of the specimen for the duration of the test. A summary of the measurements is presented in Figure 26 and the locations of these thermocouples is illustrated in Figure 5.

6.4 Deflection

All measurements are in millimeters (mm) unless stated otherwise. Positive values indicate movement towards the heating conditions.

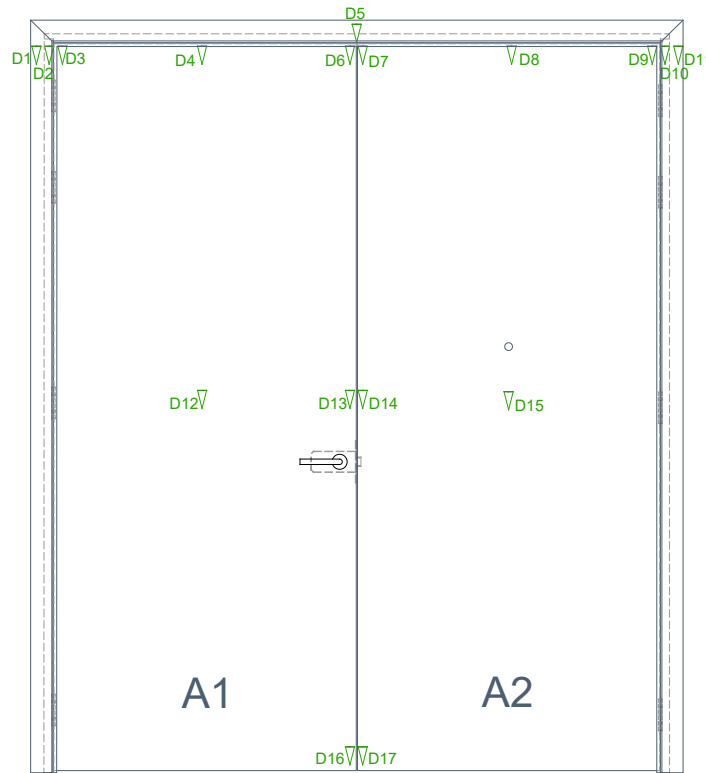

Time (mins)	D1	D2	D3	D4	D5	D6	D7	D8	D9	D10	D11	D12	D13	D14	D15	D16	D17
0	0	0	0	0	0	0	0	0	0	0	0	0	0	0	0	0	0
10	2	0	-2	-3	-5	-3	-2	-18	-2	-3	-3	-2	-7	-8	-7	-6	-4
20	-1	-2	-5	-4	-8	-7	-1	-3	-1	-3	-3	-6	-13	-10	-10	-13	-7
30	-7	-8	-9	-4	-8	-9	-6	-6	-2	-6	-6	-13	-25	-21	-17	-26	-17
40	2	0	0	-6	-6	-7	-4	-6	1	0	-2	-13	-28	-25	-18	-28	-18
50	4	6	2	-4	-3	-8	0	-3	4	2	-2	-22	-43	-41	-31	-31	-20
55	9	8	17	-8	0	-11	3	-4	9	5	2	-25	-55	-53	-39	-28	-18
60	14	10	15	-5	-3	-21	-14	-12	6	-4	0	-34	-49	-85	-55	-34	-24

7 Observations

HH	MM	SS	E3	U4	Observation
00	00	00			The test commences.
00	02	36		X	Steam/smoke releasers from meeting stile and head.
00	04	12		X	The volume of steam/smoke increases from the head and comes out from the hanging jambs and meeting stile.
00	08	15		X	Discolouring/moisture at the top corners.
00	18	28		X	Discolouring at meeting stile.
00	25	32	X		Architraves detaching around perimeter. Closers still attached at the head.
00	28	19		X	Lippings moving away from core at top leading corners and upper half of meeting stile.
00	34	24	X		Closers detached from door face.
00	48	34		X	Spy viewer melting away from face.
00	51	22		X	Moisture forming along head.
00	55	08		X	Glowing at head.
00	56	46		X	Cotton pad test head applied at the head of the doorset, the cotton pad is discoloured but no signs of embers.
00	59	09		X	Cotton pad test head applied at the head of the doorset, the cotton pad is discoloured but no signs of embers.
01	01	10		X	A flame emits and sustains for a duration greater than 10 seconds at the top left corner of the specimen. Sustained flame failure and by virtue insulation failure is deemed to occur.
01	01	32		X	A flame emits and sustains for a duration greater than 10 seconds at the top of the meeting stile.
01	01	54		X	Cotton pad test applied at the meeting stile around the lock area, the cotton pad is discoloured but no signs of embers.
01	02	51			The test is discontinued at the request of the Test Sponsor.

³ Viewed from exposed surface of the test construction.

⁴ Viewed from unexposed surface of the test construction.

8 Test Images



Figure 14 – The exposed surface of the test construction prior to commencement of the test



Figure 15 - The unexposed surface of the test construction prior to the commencement of the test



Figure 16 - The unexposed surface of the test construction after a test duration of 20 minutes



Figure 17 - The unexposed surface of the test construction after a test duration of 30 minutes



Figure 18 - The unexposed surface of the test construction after a test duration of 40 minutes



Figure 19 - The unexposed surface of the test construction after a test duration of 50 minutes



Figure 20 - The unexposed surface of the test construction after a test duration of 55 minutes



Figure 21 - The unexposed surface of the test construction after a test duration of 60 minutes



Figure 22 - The unexposed surface of the test construction after a test duration of 62 minutes



Figure 23 - The exposed surface of the test construction after the test was discontinued

9 On-going Implications

9.1 Limitations

The results relate only to the behaviour of the specimen of the element of construction under the particular conditions of test. They are not intended to be the sole criteria for assessing the potential fire performance of the element in use, nor do they reflect the actual behaviour in fires.

BS 476-20: 1987 § Appendix A provides guidance information on the application of fire resistance tests and the interpretation of results. Application of the results to products of different specification, including but not limited to differences in dimension; installation methodologies; supporting construction and components should be subject to design appraisal by a competent individual.

The tested specimen was asymmetrical and were tested such that the door leaves opened towards the heating conditions of the test. The test results may not be appropriate to situations where the door leaves open away from the heating conditions.

9.2 Accuracy of Results

Because of the nature of fire resistance testing and the consequent difficulty in quantifying the uncertainty of measurement of fire resistance, it is not possible to provide a stated degree of accuracy of the result.

No statement of conformity with the testing specifications is made or implied in this report. However, measurement results are reviewed, where applicable, to establish where measurement results exceed the control parameters established in the relevant resistance to fire test standard.

9.3 Fire Test Study Group (FTSG)

Where areas of the test specification are ambiguous or open to interpretation the Fire Test Study Group (FTSG) Resolutions have been followed (where appropriate). These Resolutions provide the basis of common agreements between the fire test laboratories which are members of this Group.

10 Figures

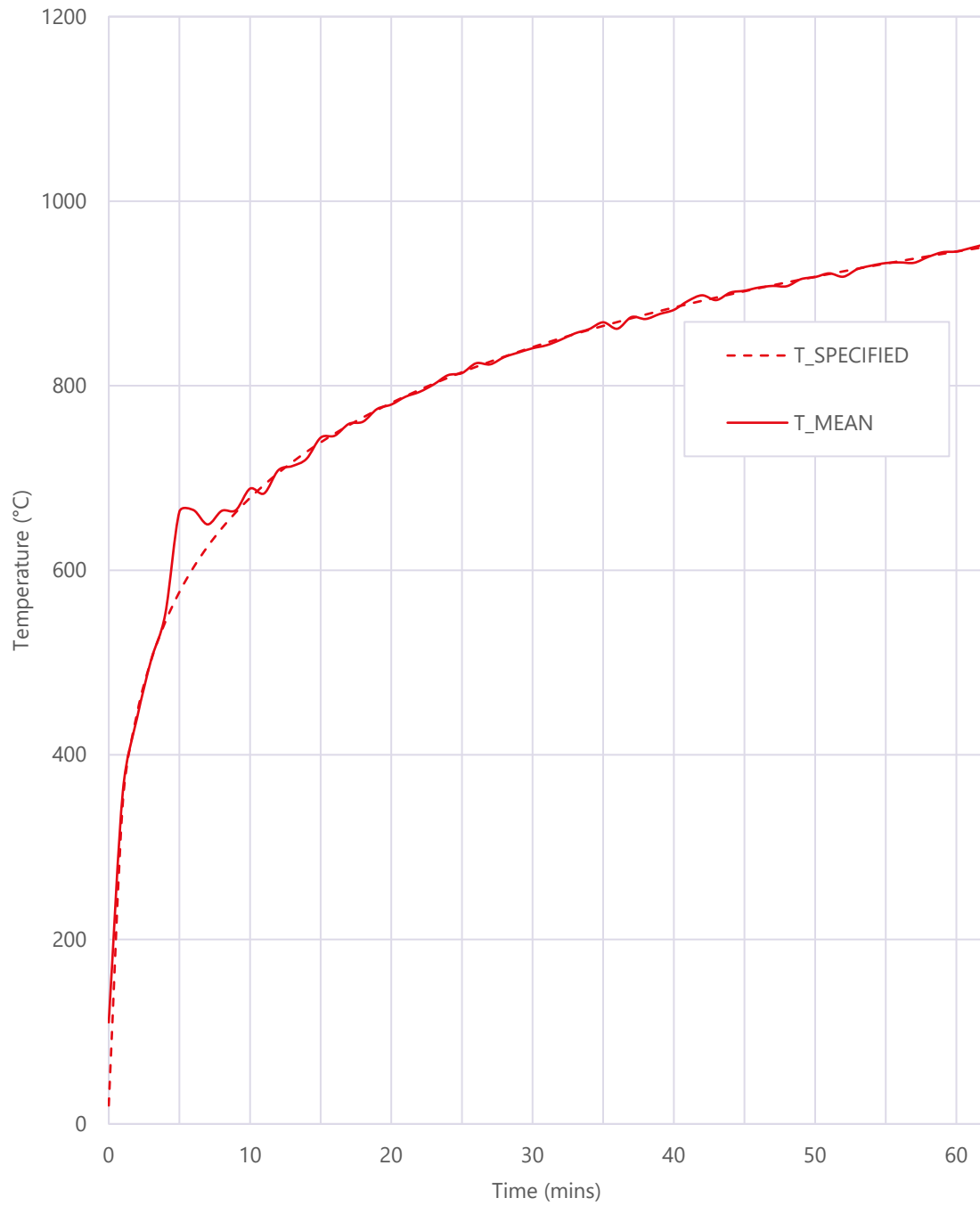

Figure 24 – Graph presenting the Time-Temperature distribution of the furnace

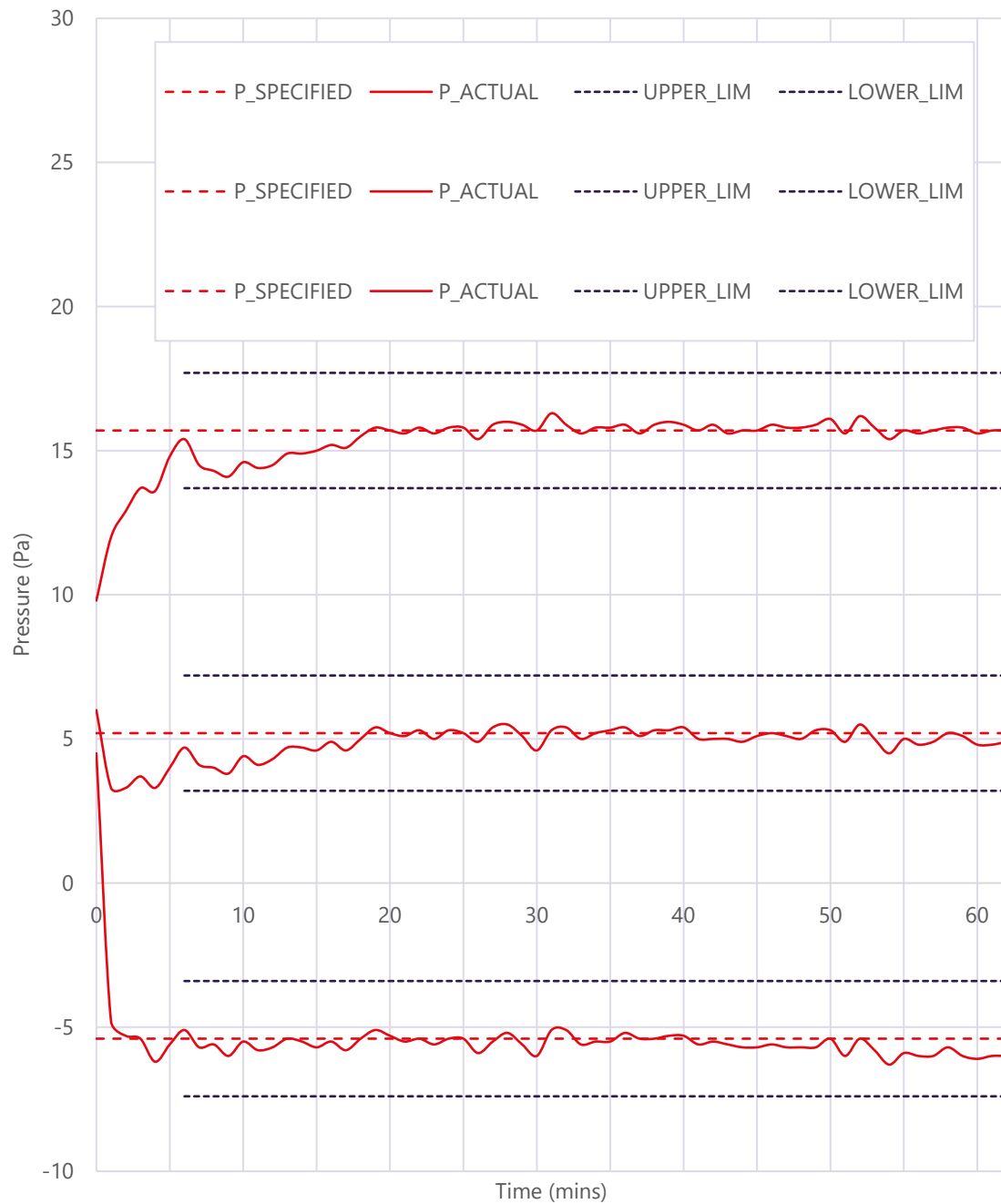

Figure 25 – Graph presenting the Time-Pressure distribution of the furnace

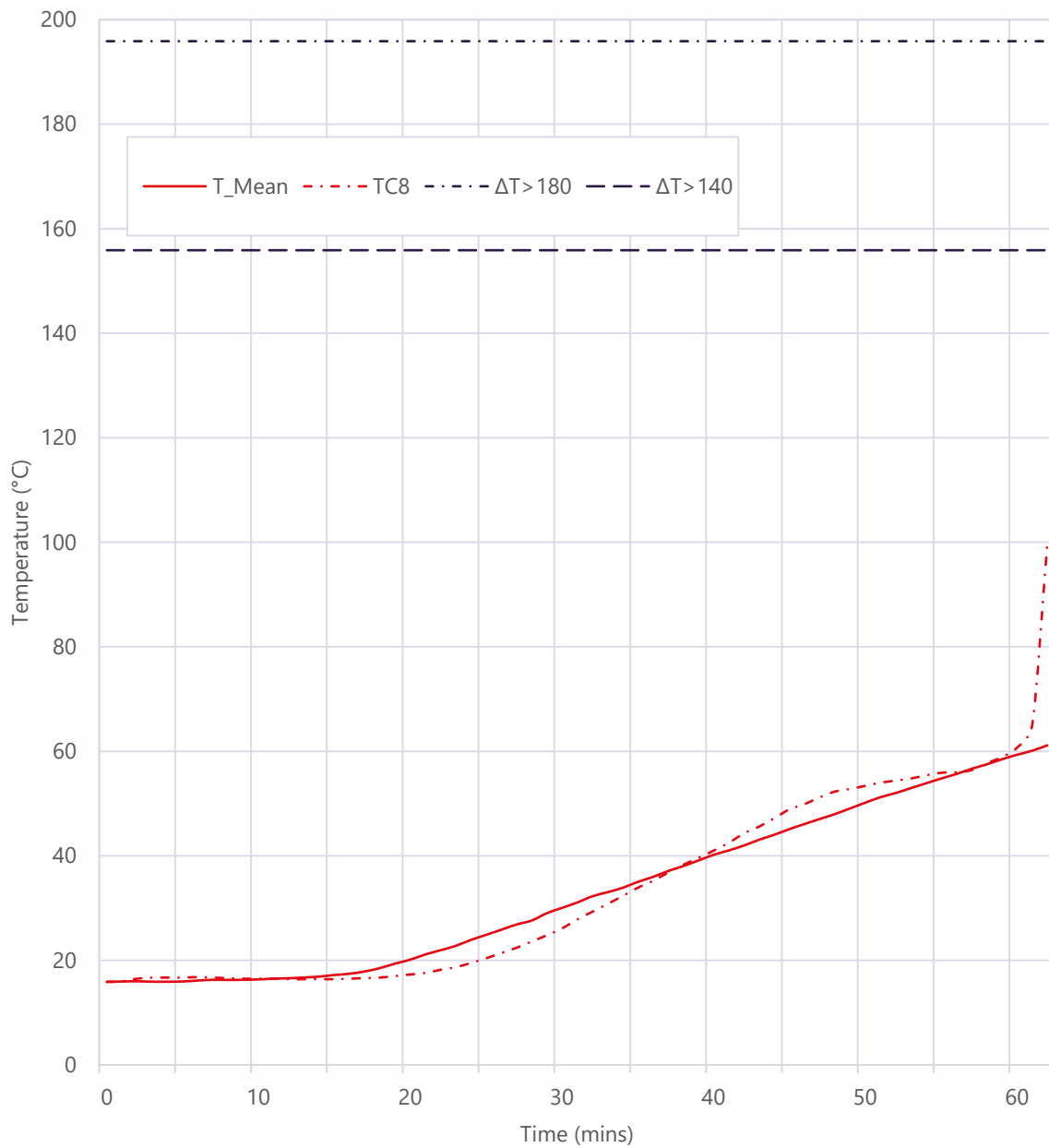

Figure 26 - Graph presenting the Time-Temperature distribution of the unexposed surface of The Specimen

11 Tables



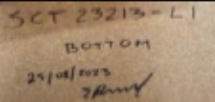
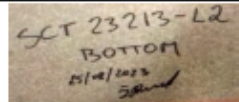



Table 1 – The temperatures recorded by the disc thermocouples used evaluate the mean and maximum temperature rise of the unexposed surface of The Specimen. Values are in Degrees Celsius (°C) unless otherwise stated.

Time (mins)	TC1	TC2	TC3	TC4	TC5
0	16.0	16.1	15.8	15.9	15.6
3	16.0	16.3	15.9	15.8	15.6
6	16.1	16.7	16.3	15.9	15.7
9	16.2	16.6	16.7	16.0	15.9
12	16.3	16.6	17.9	16.1	16.0
15	16.7	16.9	19.6	16.6	16.2
18	17.8	18.0	21.5	18.0	17.3
21	19.6	19.8	26.4	20.5	19.4
24	22.0	22.1	30.2	23.3	22.0
27	24.6	24.6	34.4	26.1	24.6
30	27.5	27.5	38.7	29.1	27.4
33	30.4	30.2	42.8	31.8	30.0
36	33.4	33.0	46.1	34.7	32.6
39	36.4	35.9	50.2	37.7	35.4
42	39.3	38.7	53.6	40.3	38.0
45	42.4	41.6	57.4	43.4	40.8
48	45.3	44.7	60.1	46.3	43.6
51	48.5	47.8	63.2	49.8	46.8
54	51.6	50.8	65.3	52.6	49.1
57	54.6	53.9	67.6	55.3	51.9
60	57.7	56.5	70.3	57.9	54.3
62	59.7	58.6	71.7	59.6	56.1

Table 2 – The temperatures recorded by the disc thermocouples used to evaluate the maximum temperature rise of The Specimen. Values are in Degrees Celsius (°C) unless otherwise stated.

Time (mins)	TC6	TC7	TC8	TC9
0	15.6	15.8	15.9	16.3
3	15.6	17.1	16.7	16.2
6	15.6	17.6	16.8	16.3
9	15.7	18.5	16.5	16.3
12	15.7	17.4	16.4	16.4
15	15.7	17.2	16.4	16.3
18	15.8	17.1	16.7	16.4
21	16.0	17.6	17.6	16.5
24	16.4	18.4	19.5	16.7
27	17.1	19.5	22.4	16.9
30	19.2	20.4	26.1	17.2
33	23.4	21.6	30.8	17.6
36	28.2	23.1	35.2	18.2
39	32.0	24.4	39.6	18.6
42	34.8	26.3	44.3	19.3
45	36.7	27.7	48.9	20.1
48	38.1	30.4	52.3	21.0
51	39.1	31.8	54.0	21.9
54	39.7	34.4	55.4	23.4
57	40.1	35.7	56.4	25.7
60	40.4	38.6	60.7	28.8
62	41.0	59.6	99.8	30.9

Appendix A Sample Report

 Proud to be part of 		SAMPLING VISIT REPORT		Company Name	Exitex UK Sales LTD
				Establishment No.	05C/21255 (E002626)
				BM TRADA Notified Body ID: 1224	
Company Head Office Address	Exitex UK Sales LTD St Johns Chambers Love St Chester CH1 1QN		Contact Name	Des Gray	
			Telephone		
			Email Address	Des.Gray@exitex.com	
Location where sampling was conducted if different from Head Office Address			Visit Date	BMT Representative	
Dorsuite Ltd, 17 Law Place, Nerston Industrial Estate, East Kilbride, Glasgow G74 4QL			25/08/2023	Chris Blount	
Requirement		Evidence / Comments			
Opening Meeting (names of those present)		Alan Little (Dorsuite) / Chris Blount (BM TRADA)			
Contract Reference		SCT23213			
Technical Specification document / FoA reference Photographs to be taken of all critical areas highlighted in the Technical Specification		Exitex - TST - Strebord 54 - SCT23213 Changes updated to -Exitex - TST - Strebord 54 - SCT23213 - Verified by CGB 250823			
Description of product(s) sampled		Falcon Strebord (54mm) unglazed double door leaves lipped with sapele lippings, hung in a sapele frame on 4 no hinges per leaf. Leaf 1 fitted with tubular latch, lever handle and drop down seal. Leaf 2 fitted with door viewer, latch keep, door closer and drop down seal.			
Product identification / reference numbers / codes		SCT23213 (Dorsuite job 16906)			
Batch number(s)		NA			
Date of manufacture		25/08/2023			
Quantity of stock and size of sample(s) taken		1no. double doorset (Frame 2074mm x 2440mm) (Leaf 1 & 2 1000mm x 2400mm)			
Traceability of material records ie Purchase Orders and delivery notes		PO 78250 – Falcon Strebord 54mm core – Falcon Panel Products 27/04/2023 DIN S-472115 – hardware & Intumescent – Exitex 27/07/2023 PO 71494 – Hinges - Zoo Architectural Hardware 06/09/2022 PO 80508 – Tubular Latch - Zoo Architectural Hardware 25/07/2023 Warrington Fire Sampling Report FM517025 – LT 15x4 Intumescent strips – 25/08/2022 All Purchase orders held on file at BM TRADA			
Example of sampler's markings applied to the product(s) (contract reference, signature of client, date of manufacture)		 			
Confirmation of minimum mandatory video/live checks undertaken		<input checked="" type="checkbox"/> Glazing assembly (where applicable) <input checked="" type="checkbox"/> Hardware prep and fitting (where applicable)		<input checked="" type="checkbox"/> Finished doorset with markings <input checked="" type="checkbox"/> Sampling pack discussion	
Details of any further FPC processes witnessed during the visit.		none			
Determine the essential characteristics of the product and confirm the details of in-process checks conducted on the sample to ensure conformity.		Falcon Strebord (54mm) unglazed double door leaves lipped with 8mm sapele lippings, hung in sapele frame (100mm x 32mm with a 32mm x 12mm planted stop) on 4 no hinges per leaf (with EX0-Fire 2mm Graphite Intumescent pads) 2no. 15mmx4mm Exitex LT Intumescent strip to frame rebate and meeting stile of Leaf 1. Leaf 1 fitted with tubular latch (with EXI-Fire 2mm Graphite Intumescent to body & forend), lever handle and drop down seal. Leaf 2 fitted with door viewer (with EXI-Fire 1mm Graphite Intumescent wrap), latch keep (with EXI-Fire 2mm Graphite Intumescent) and drop down seal. Face fix door closer parts verified and signed – to be fitted on installation. Door leaf to be removed from frame for transportation and re-hung at test lab.			
State any items from the Technical Specification / FoA that were not witnessed and require further lab sampling		<input type="checkbox"/> Side screen / overpanel <input checked="" type="checkbox"/> Door closer		<input type="checkbox"/> Handles <input checked="" type="checkbox"/> Door re-hanging <input checked="" type="checkbox"/> Other (see tech spec marked with 'not seen')	
Confirm any clauses within the Technical Specification that were found to be different on the sampled product/s. Non-conformances may be raised for pre-cert and audit test sampling		Exitex - TST - Strebord 54 - SCT23213 original spec updated to Exitex - TST - Strebord 54 - SCT23213 - Verified by CGB 250823 within sections; 1, 3, 7, 9, 10, 11, 12, 13, 14, 15, 16, 17, 18, 19, 20, 21 & 22			
Closing Meeting (names of those present)		Alan Little (Dorsuite) / Chris Blount (BM TRADA)			
Declaration		I declare that the product/s witnessed during this sampling visit are representative of normal production.			
Company Representative Name (Print)		Company Representative Position			
Desmond Gray		Alan Little		Sales Director	
BM TRADA Representative Signature		Company Representative Signature			
					
This sampling report remains the property of BM TRADA. BM TRADA shall keep confidential all information relating to the sampling process and your organisation and shall not disclose such information to any third party except as required by law or by BM TRADA's Accreditation Bodies. This sampling report will be shared with others within Warringtonfire Testing and Certification Ltd.					